

Think

Architecture

Architecture
Interior Design
Landscape Architecture
Land Planning
Construction Management

5151 South 900 East, Suite 200
Salt Lake City, UT 84117
Ph: 801.269.0055
Fax: 801.269.1425
www.thinkpk.com

The designs shown and described herein including all technical drawings, graphic representation & models thereof, are proprietary & can not be copied, duplicated, or commercially exploited in whole or in part without the sole and express written permission from ASW+ISA Architects, Inc.
These drawings are available for limited review and evaluation by clients, consultants, contractors, government agencies, vendors, and office personnel only in accordance with this notice.

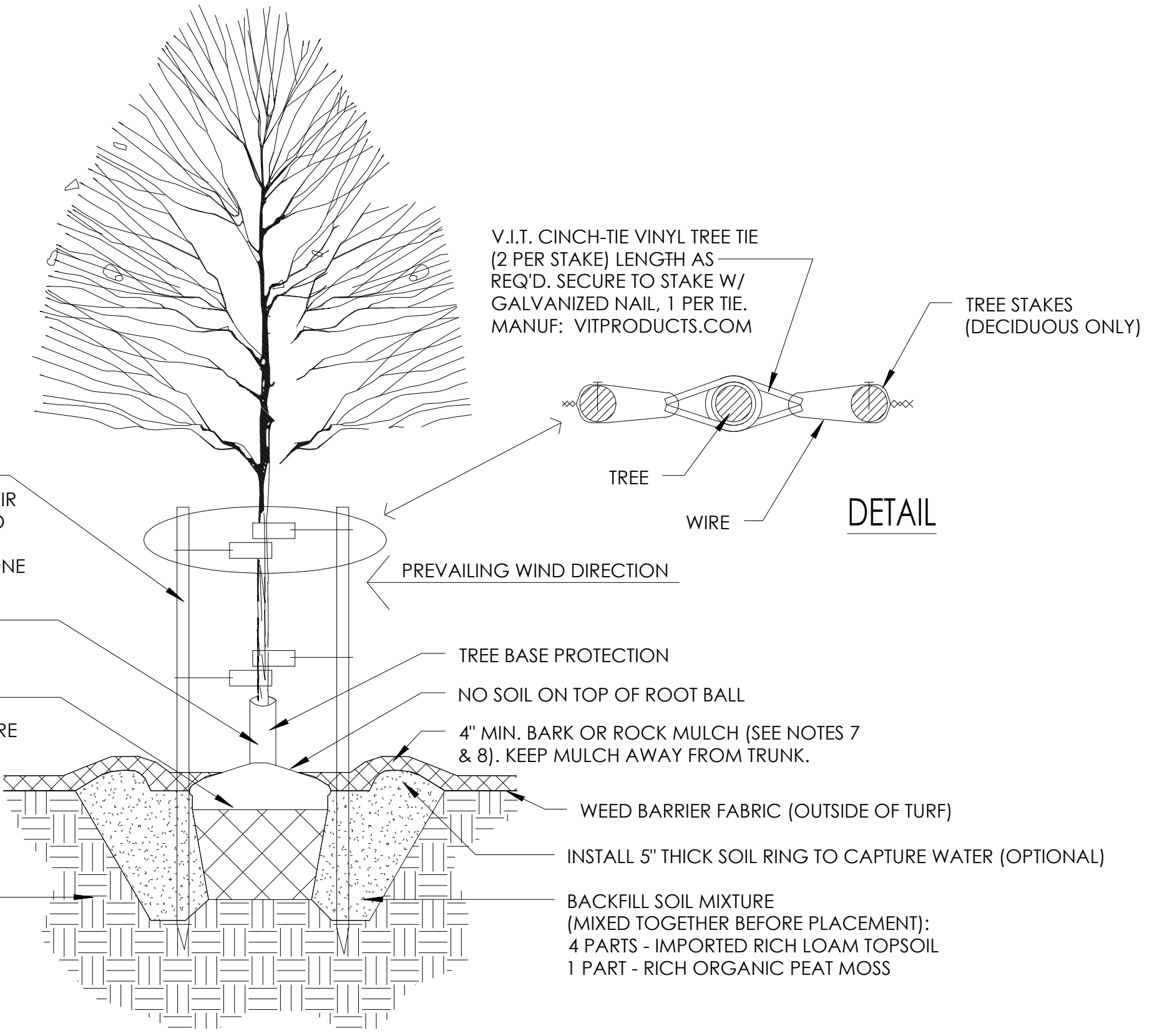
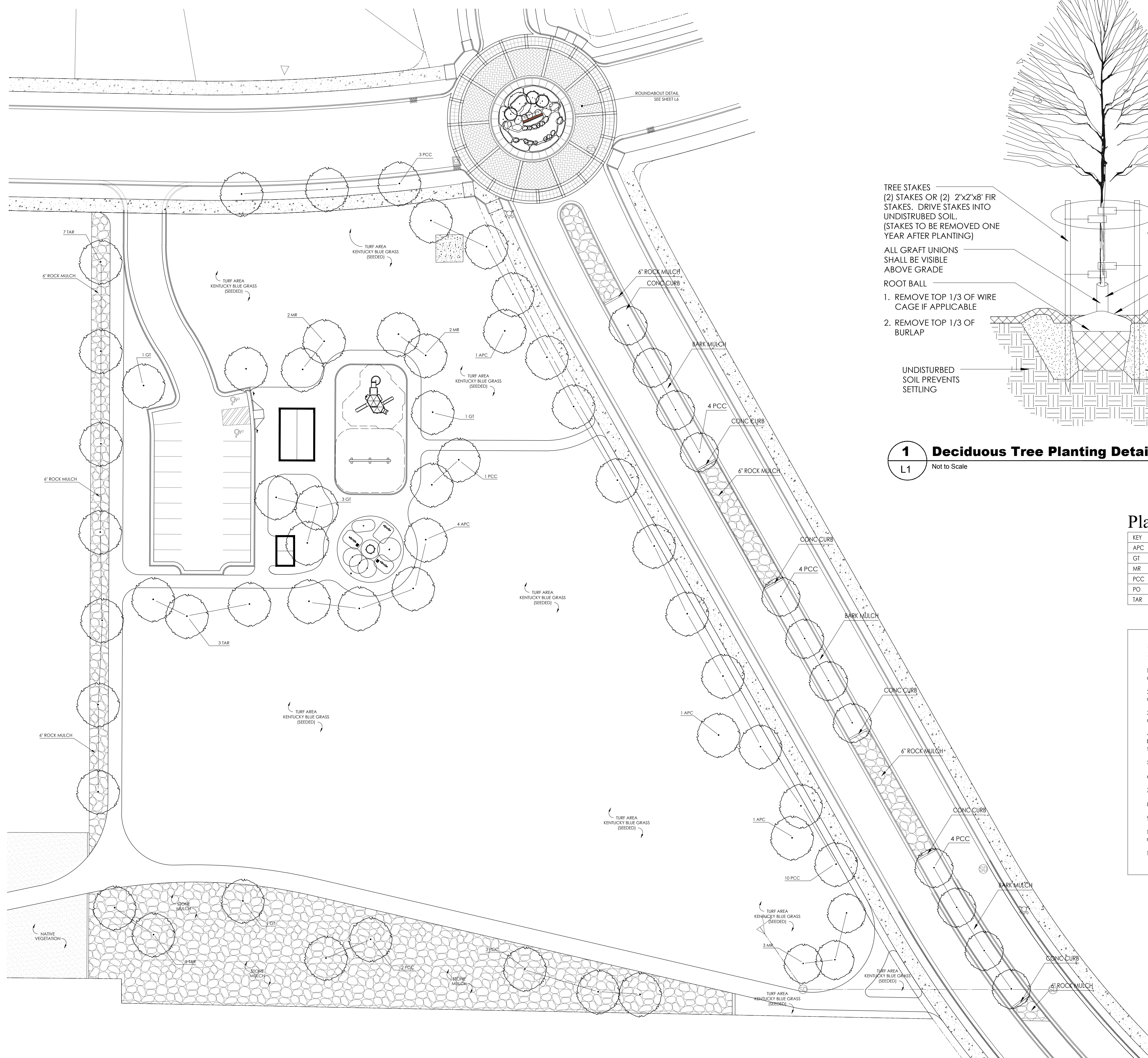

1 Deciduous Tree Planting Detail
L1 Not to Scale

Plant List

KEY	QTY	BOTANICAL NAME	COMMON NAME	SIZE
APC	7	Acer platanoides 'Crimson King'	Crimson King Maple	2' cal.
GT	6	Gleditsia triacanthos 'Shademaster'	Shademaster Honeylocust	2.25' cal.
MR	7	Malus 'Radiant'	Radiant Crabapple	2.5' cal.
PCC	31	Pyrus calleryana 'Chanticleer'	Chanticleer Pear	2' Cal.
PO	19	Platanus occidentalis	Sycamore	3-3.5"
TAR	12	Tilia americana 'Redmond'	Redmond Linden	2' cal.

Planting Notes

- All nursery stock shall meet the horticultural standards of the American Association of Nurserymen as to grading and quality.
- All plants shall conform to the measurements specified, except that plants larger than those specified may be used if approved by the Landscape Architect.
- All plants shall be nursery grown in accordance with good horticultural practices and shall be grown under climatic conditions similar to those in the project locality for at least two years.
- Balled and burlapped plants (B&B) shall be moved with the root system as solid units; root balls shall be firmly wrapped with burlap. Container grown plants shall not be removed from container prior to the time of installation; root system shall be firmly set in container.
- Planting soil mix shall consist of seven (7) parts loam and one (1) part peat moss by volume, with a pH value of 5.0 to 6.0.
- All trees to be guyed as shown in details.
- All trees and shrubs to receive two (2) fertilizer packets as shown in details.
- Planting beds to receive 4 inch depth of bark mulch.
- All plant material shall be guaranteed for one full growing season (one year) after installation.
- Any plant material which dies, turns brown or unexpectedly defoliates prior to acceptance of work shall be promptly removed from the site and replaced with material of the same species, quality, size and meeting all planting specifications.
- Planting layout shall be approved by the Landscape Architect prior to installation.

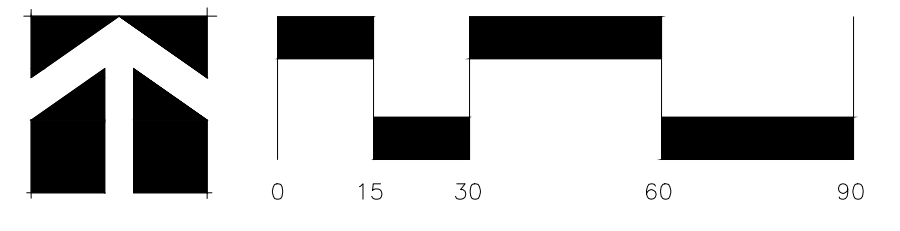

SPRING RUN PARKS
EAGLE MOUNTAIN, UTAH

PROJECT NO. 15040
DATE: November 9, 2016

REVISIONS:

SHEET TITLE:
PHASE 1
PLANTING PLAN
SHEET NUMBER:

L1
SITE

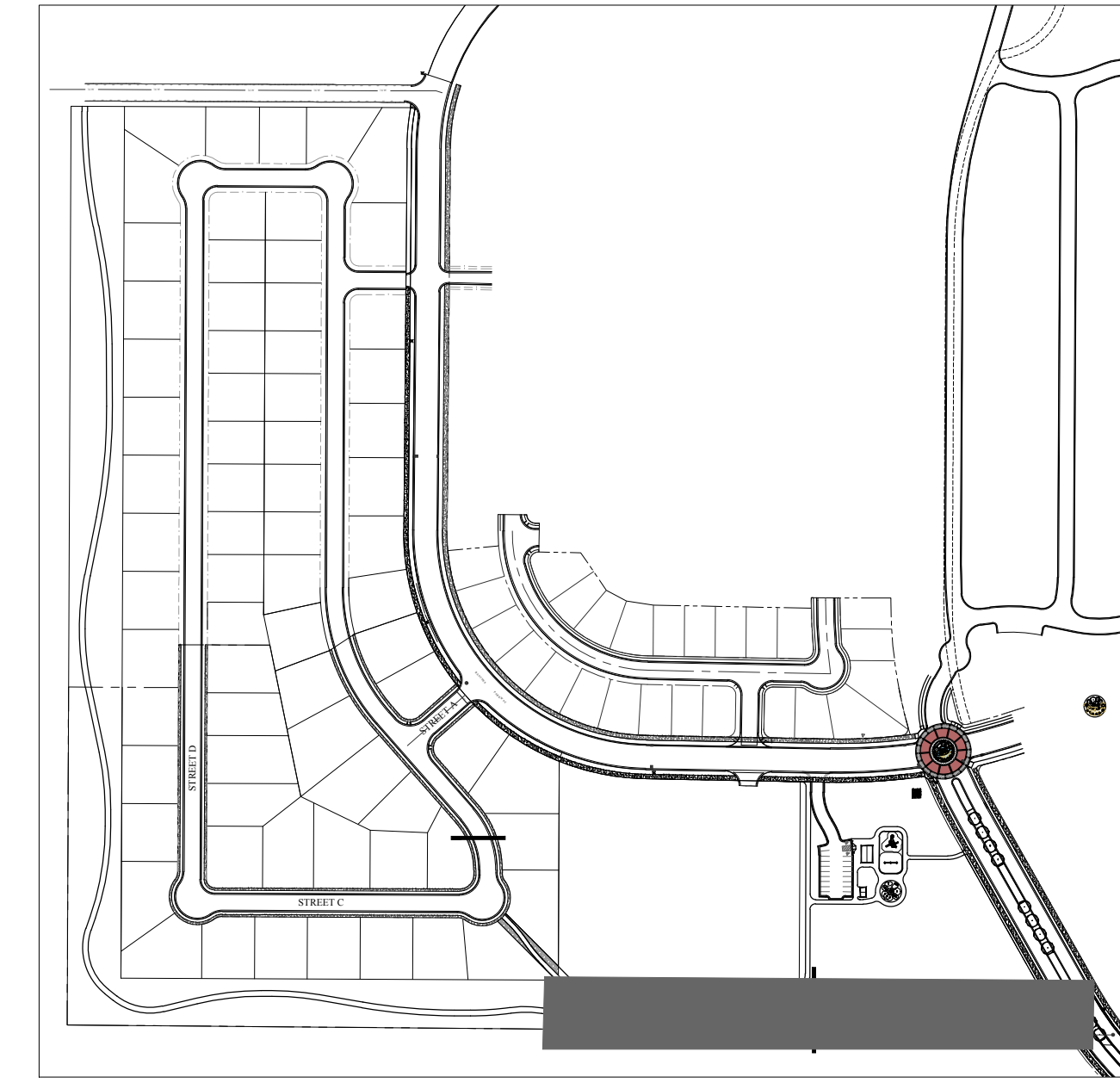
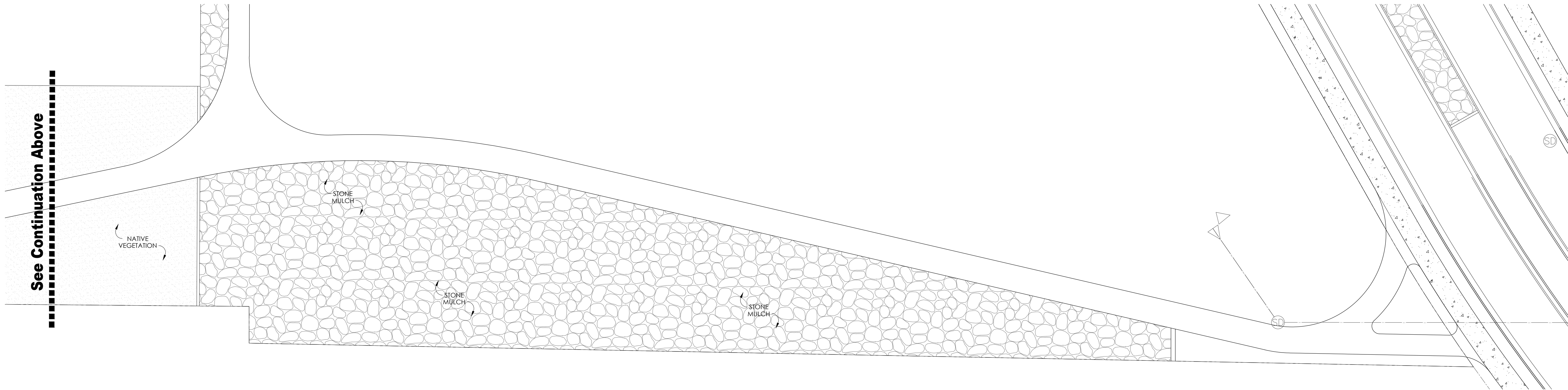
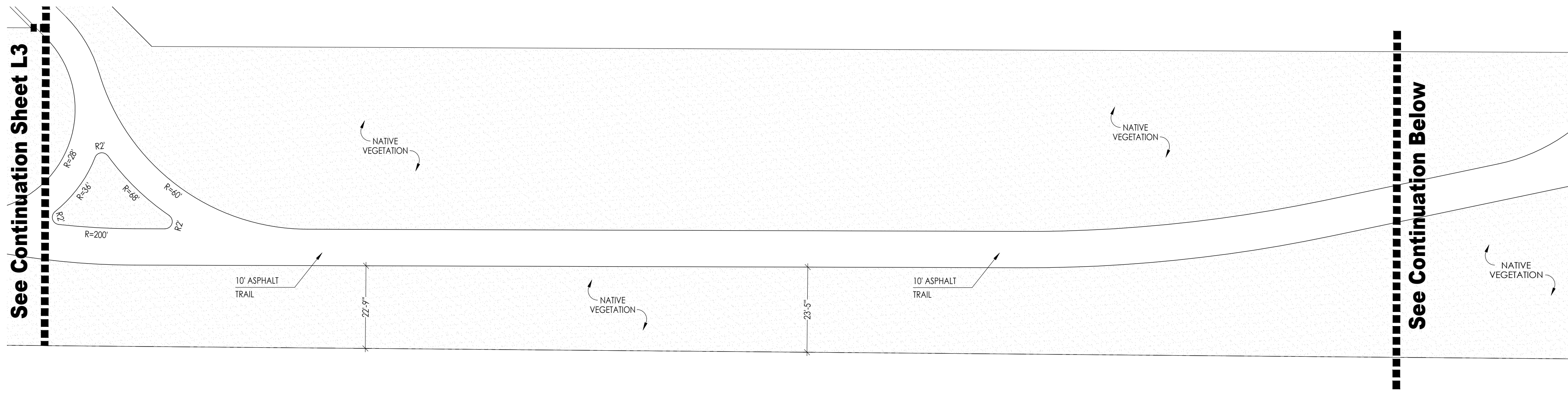

Think
Architecture

Architecture
Interior Design
Landscape Architecture
Land Planning
Construction Management

5151 South 900 East, Suite 200
Salt Lake City, UT 84117
Ph: 801.269.0355
Fax: 801.269.1425
www.thinkaec.com

The designs shown and described herein including all technical drawings, graphic representation & models thereof, are proprietary & can not be copied, duplicated, or commercially exploited in whole or in part without the sole and express written permission from ASWH+USA Architects, Inc.

These drawings are available for limited review and evaluation by clients, consultants, contractors, government agencies, vendors, and office personnel only in accordance with this notice.

SPRING RUN PARKS
PHASE 1
EAGLE MOUNTAIN, UTAH

PROJECT NO. 15040
DATE: November 9, 2016

REVISIONS:

SHEET TITLE:
Perimeter Trail
Layout Plan

SHEET NUMBER:

L2

SITE

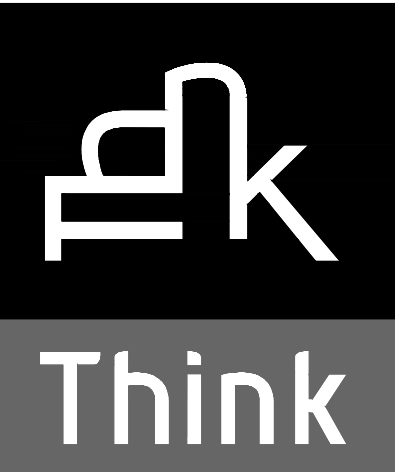

Think
Architecture

Architecture
Interior Design
Landscape Architecture
Land Planning
Construction Management

5151 South 900 East, Suite 200
Salt Lake City, UT 84117
Ph: 801.269.0055
Fax: 801.269.1425
www.thinkaec.com

The designs shown and described herein including all technical drawings, graphic representation & models thereof, are proprietary & can not be copied, duplicated, or commercially exploited in whole or in part without the sole and express written permission from ADWHA Architects, Inc.
These drawings are available for limited review and evaluation by clients, consultants, contractors, government agencies, vendors, and office personnel only in accordance with this notice.

SPRING RUN PARKS
PHASE 1
EAGLE MOUNTAIN, UTAH

PROJECT NO. 15040

DATE: November 9, 2016

REVISIONS:

SHEET TITLE:
Perimeter Trail
Layout

SHEET NUMBER:

L3

SITE

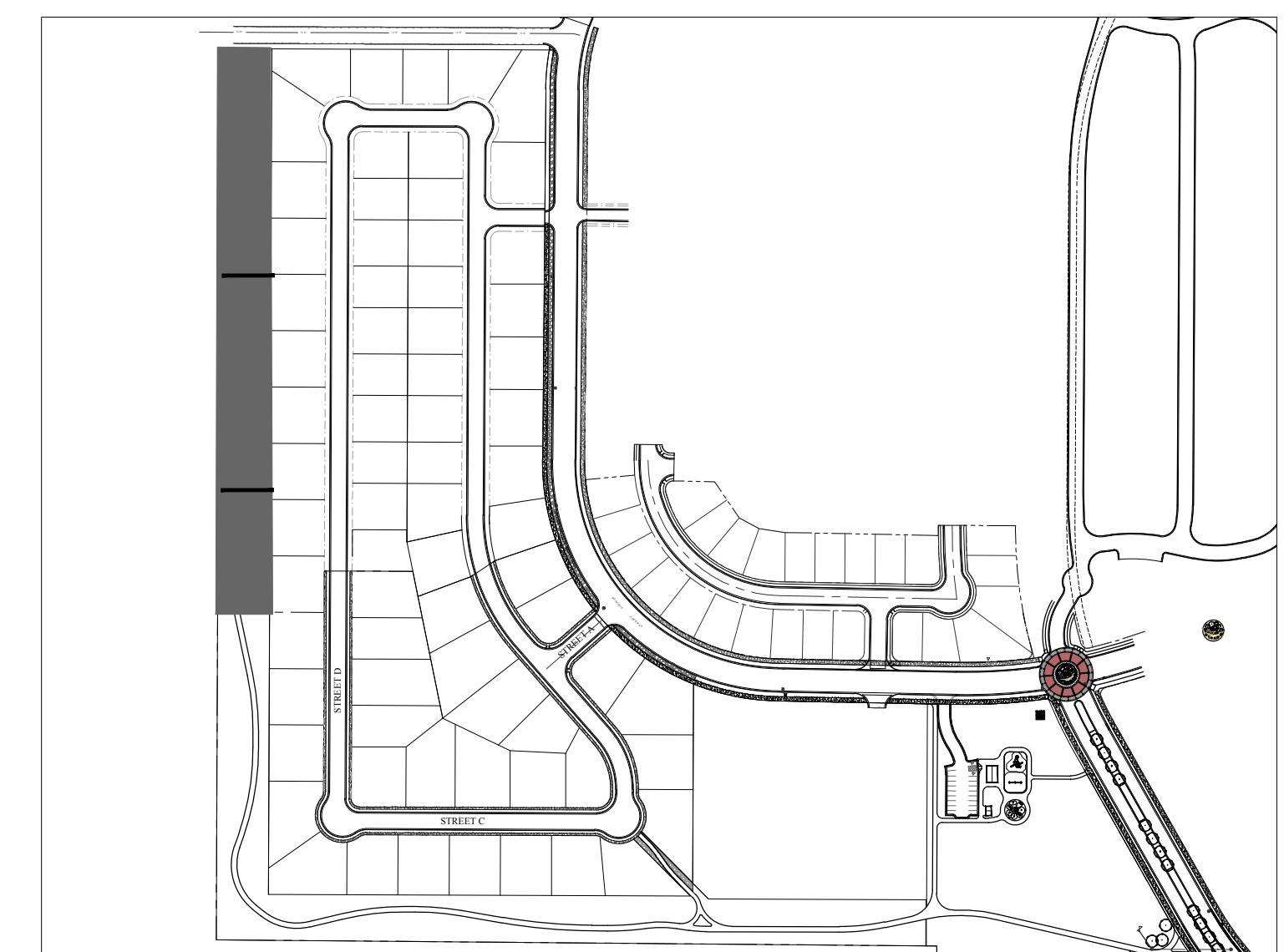
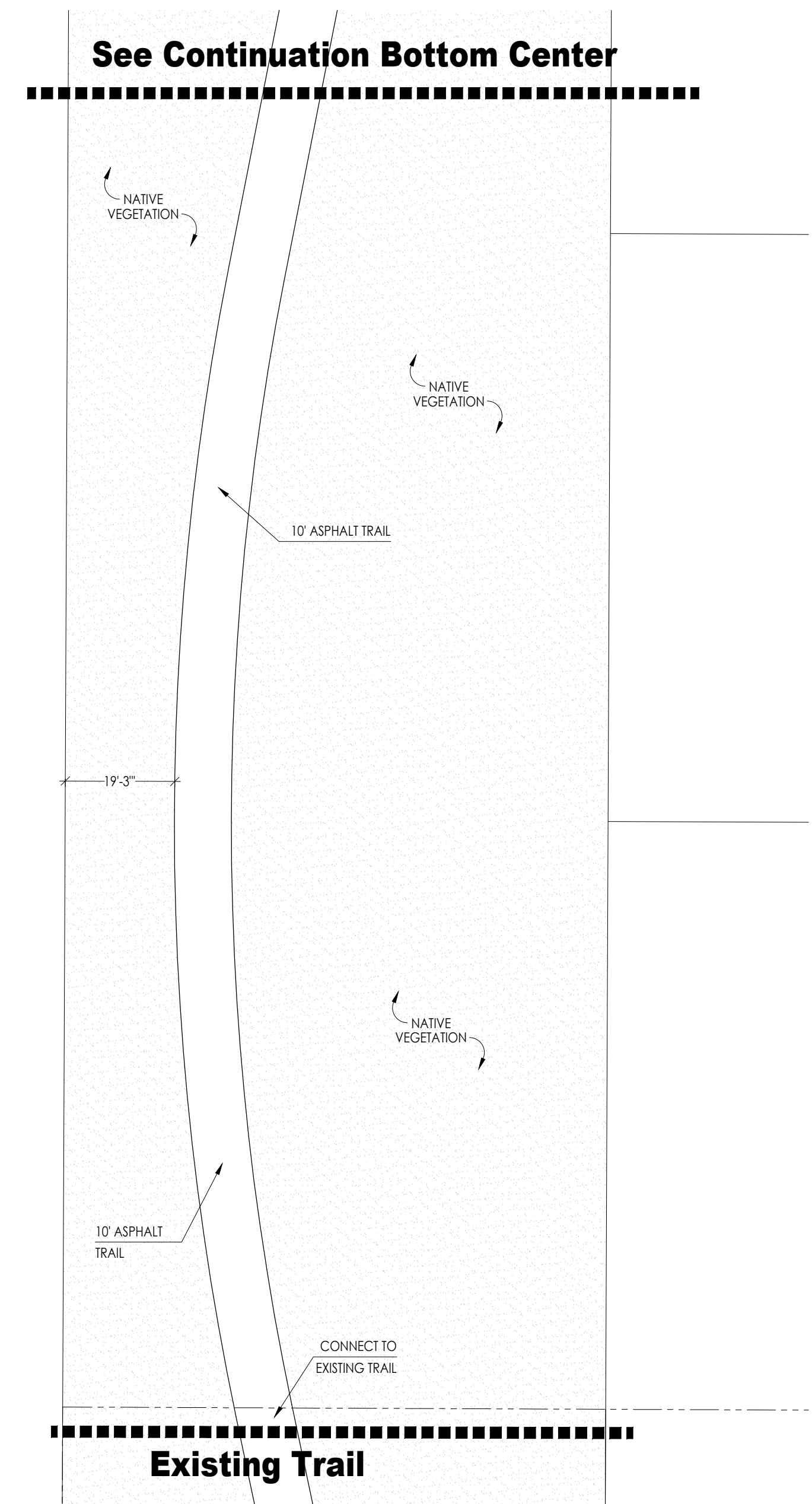
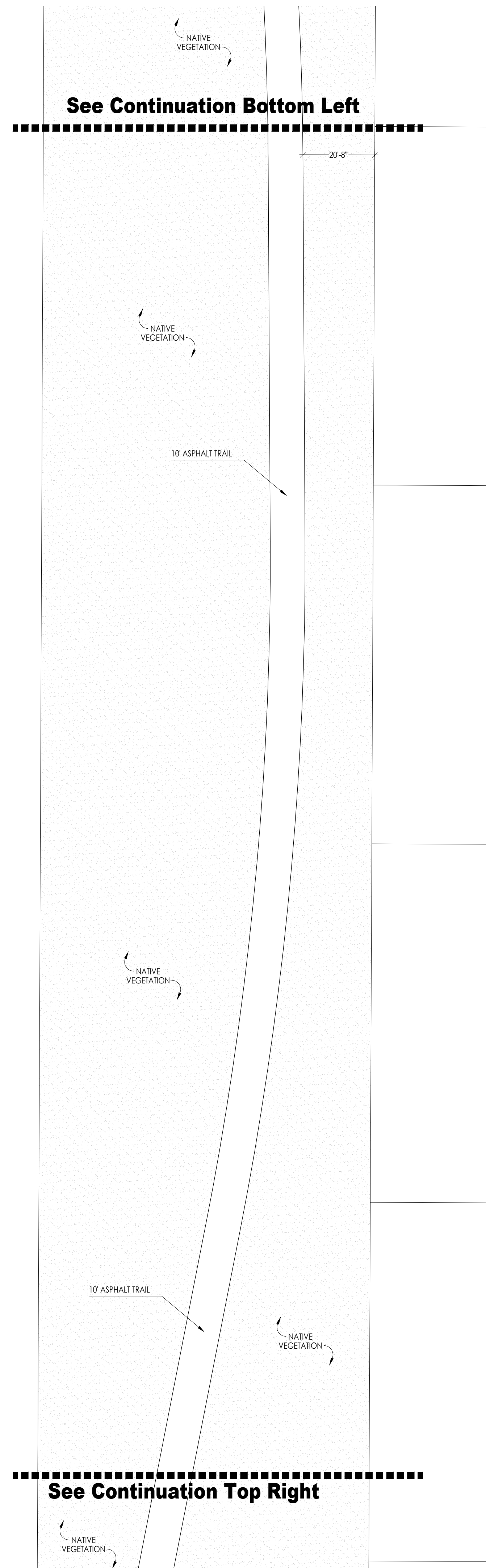
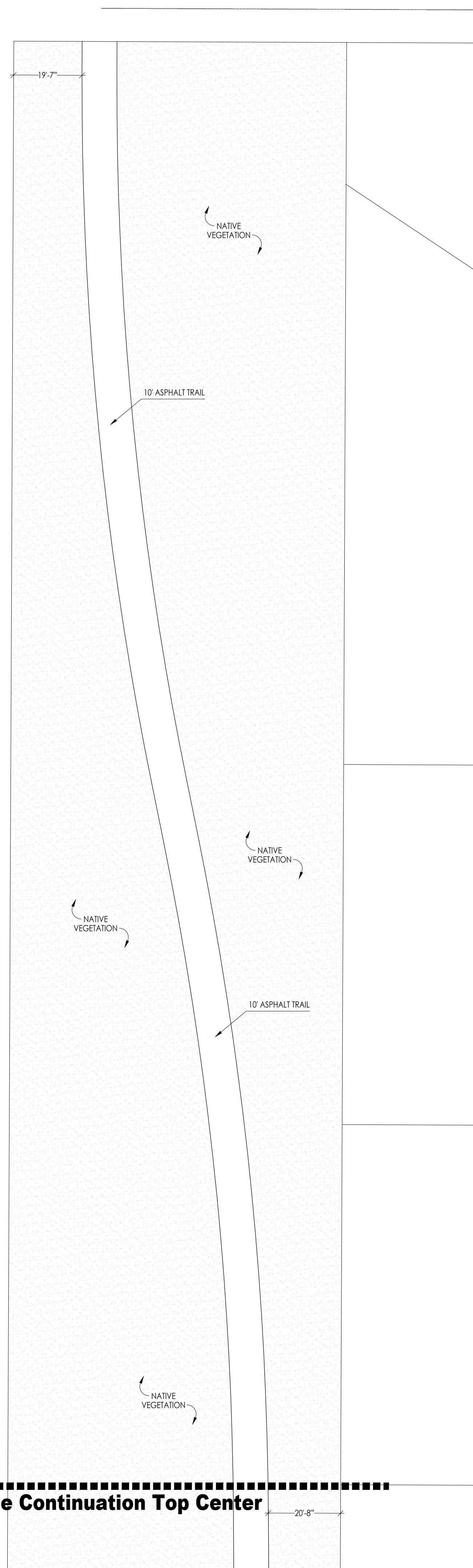



Think

Architecture
Interior Design
Landscape Architecture
Land Planning
Construction Management

1515 South 900 East, Suite 200
Salt Lake City, UT 84117
Ph: 801.269.0055
Fax: 801.269.1425
www.thinkaec.com

The designs shown and described herein including all technical drawings, graphic representation & models thereof, are proprietary & can not be copied, duplicated, or commercially exploited in whole or in part without the sole and express written permission from ASWH+ISA Architects, Inc.
These drawings are available for limited review and evaluation by clients, consultants, contractors, government agencies, vendors, and office personnel only in accordance with this notice.

SPRING RUN PARKS
PHASE 1
EAGLE MOUNTAIN, UTAH

PROJECT NO. 15040
DATE: November 9, 2016
REVISIONS:

SHEET TITLE:
Phase 1
Planting Plan

SHEET NUMBER:

L4

SITE

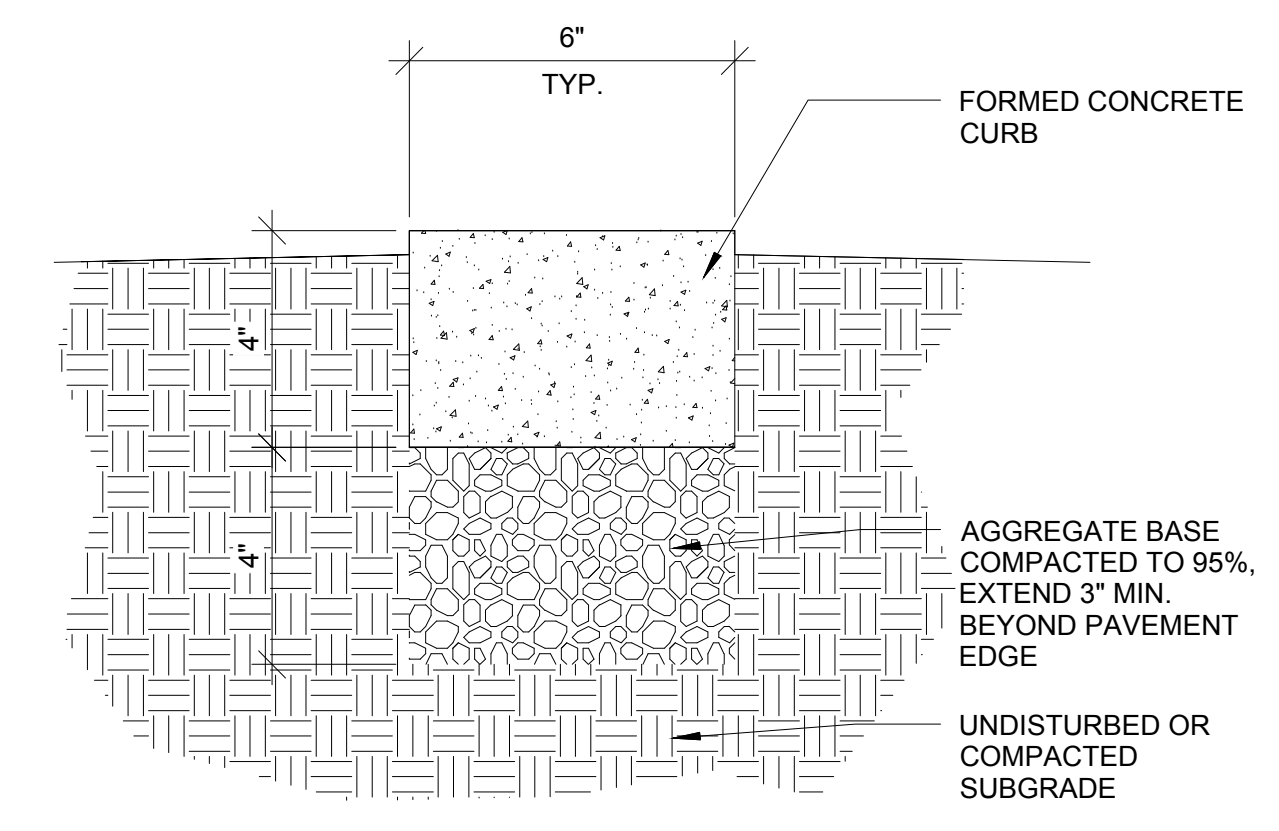
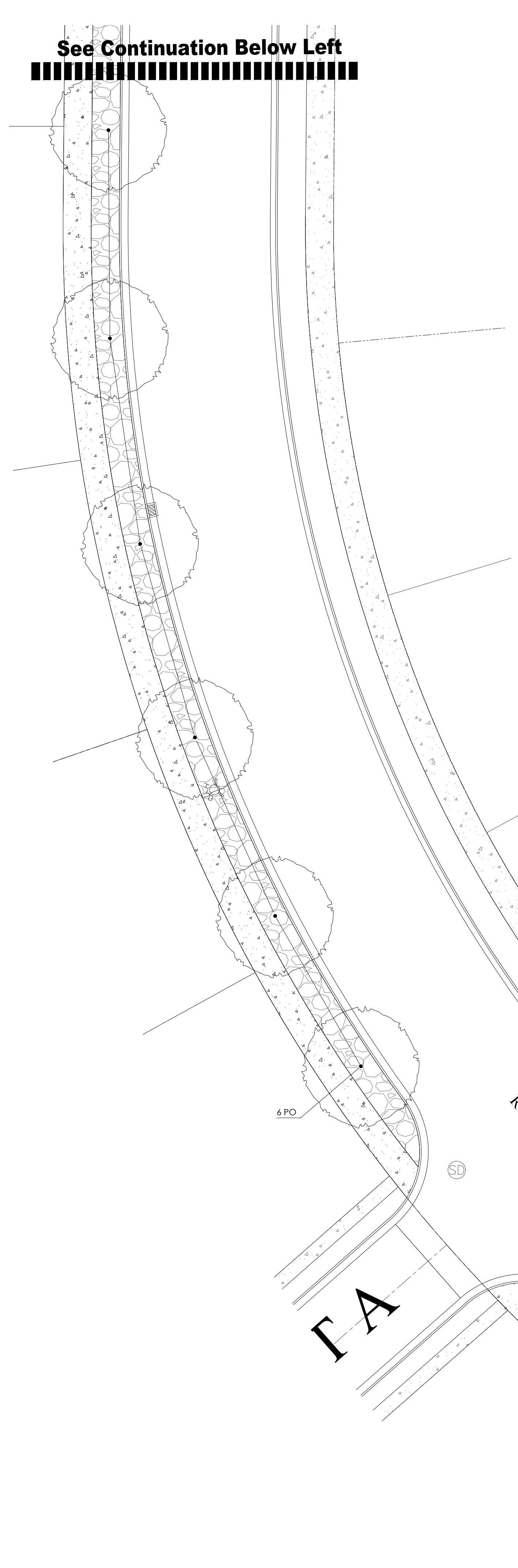
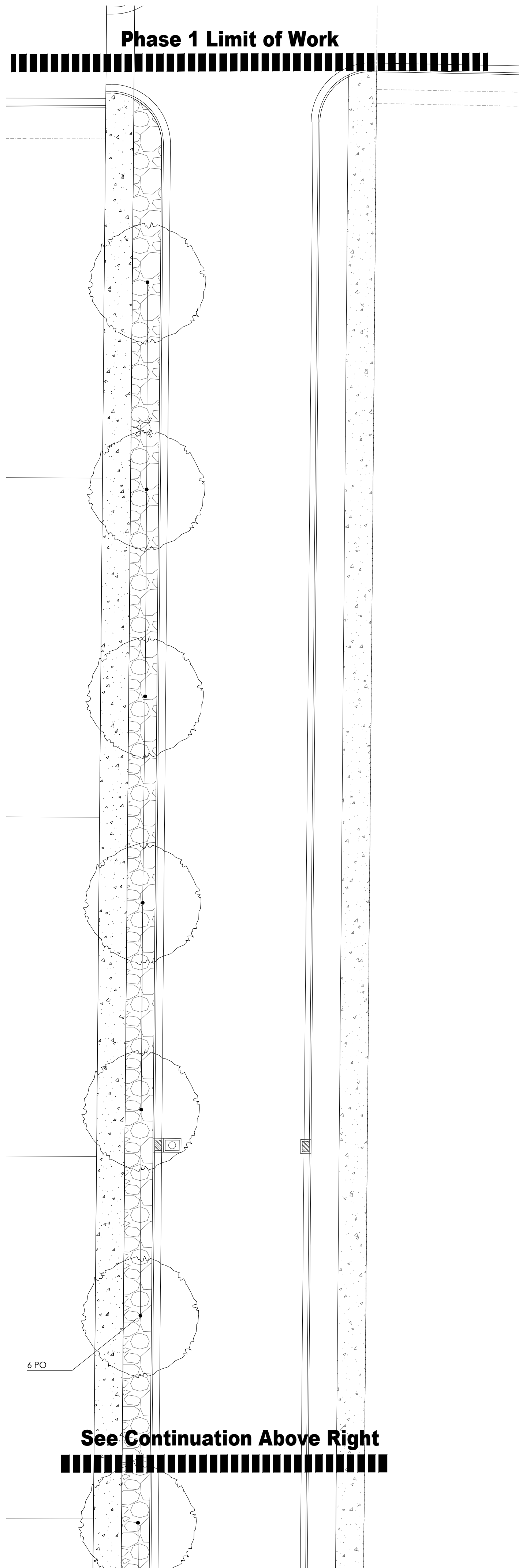

NOTE: CONSTRUCTION STRIKE JOINT EVERY 5 L.F. (TYP.)

1 Concrete Mow Strip
L4 Not to Scale

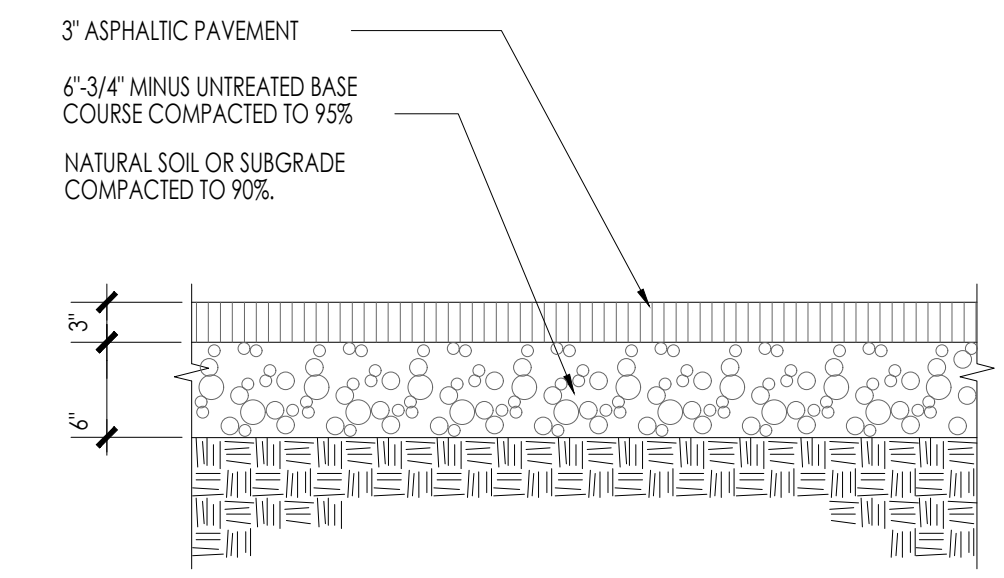

2 Asphalt Trail
L4 Not to Scale

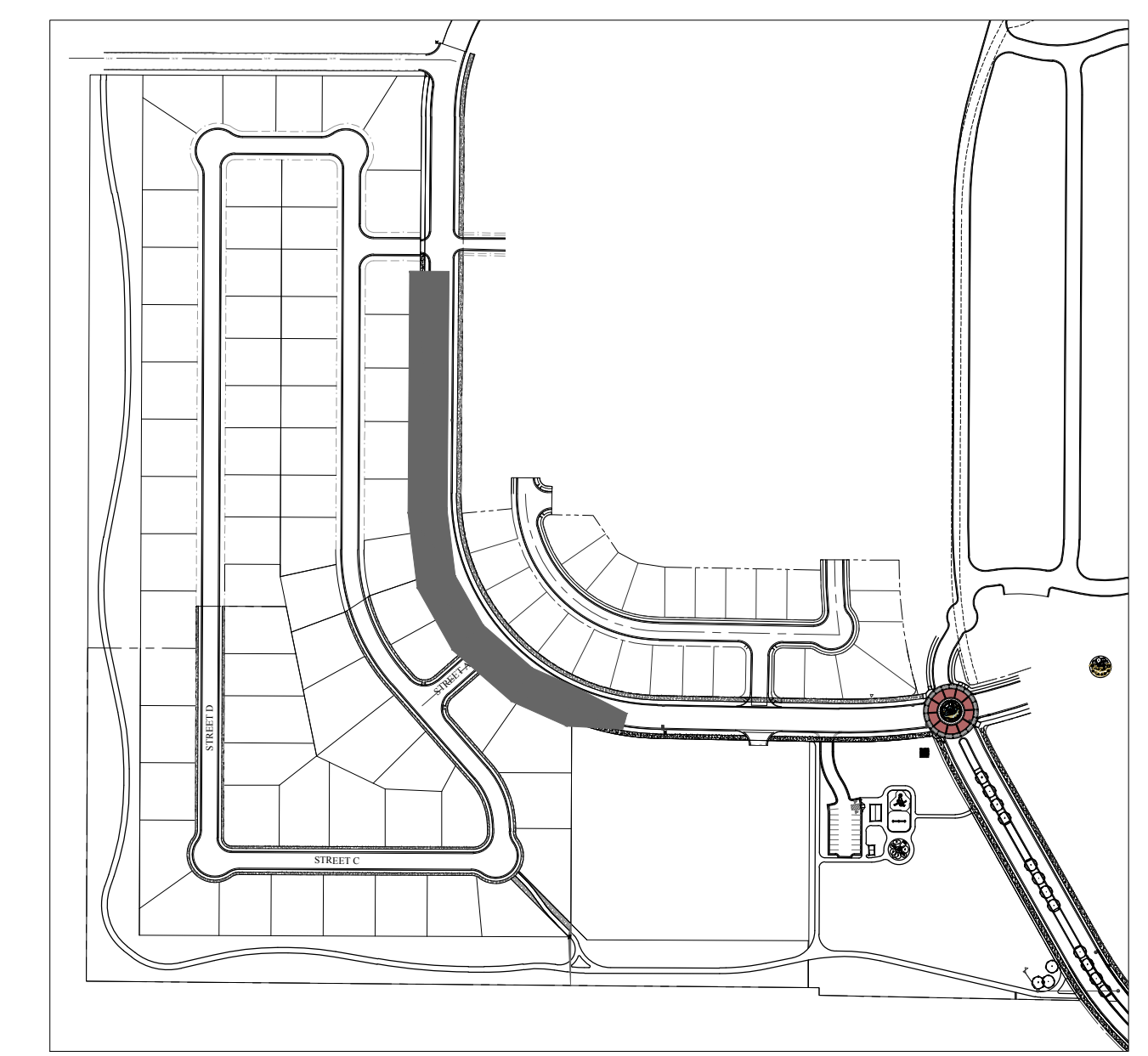

Plantings in Church Frontage by LDS Church



Think

Architecture
Interior Design
Landscape Architecture
Land Planning
Construction Management

5151 South 900 East, Suite 200
Salt Lake City, UT 84117
Ph: 801.269.0055
Fax: 801.269.1425
www.thinkaec.com

The designs shown and described herein including all technical drawings, graphic representation & models thereof, are proprietary & can not be copied, duplicated, or commercially exploited in whole or in part without the sole and express written permission from ASWH+USA Architects, Inc.
These drawings are available for limited review and evaluation by clients, consultants, contractors, government agencies, vendors, and office personnel only in accordance with this notice.

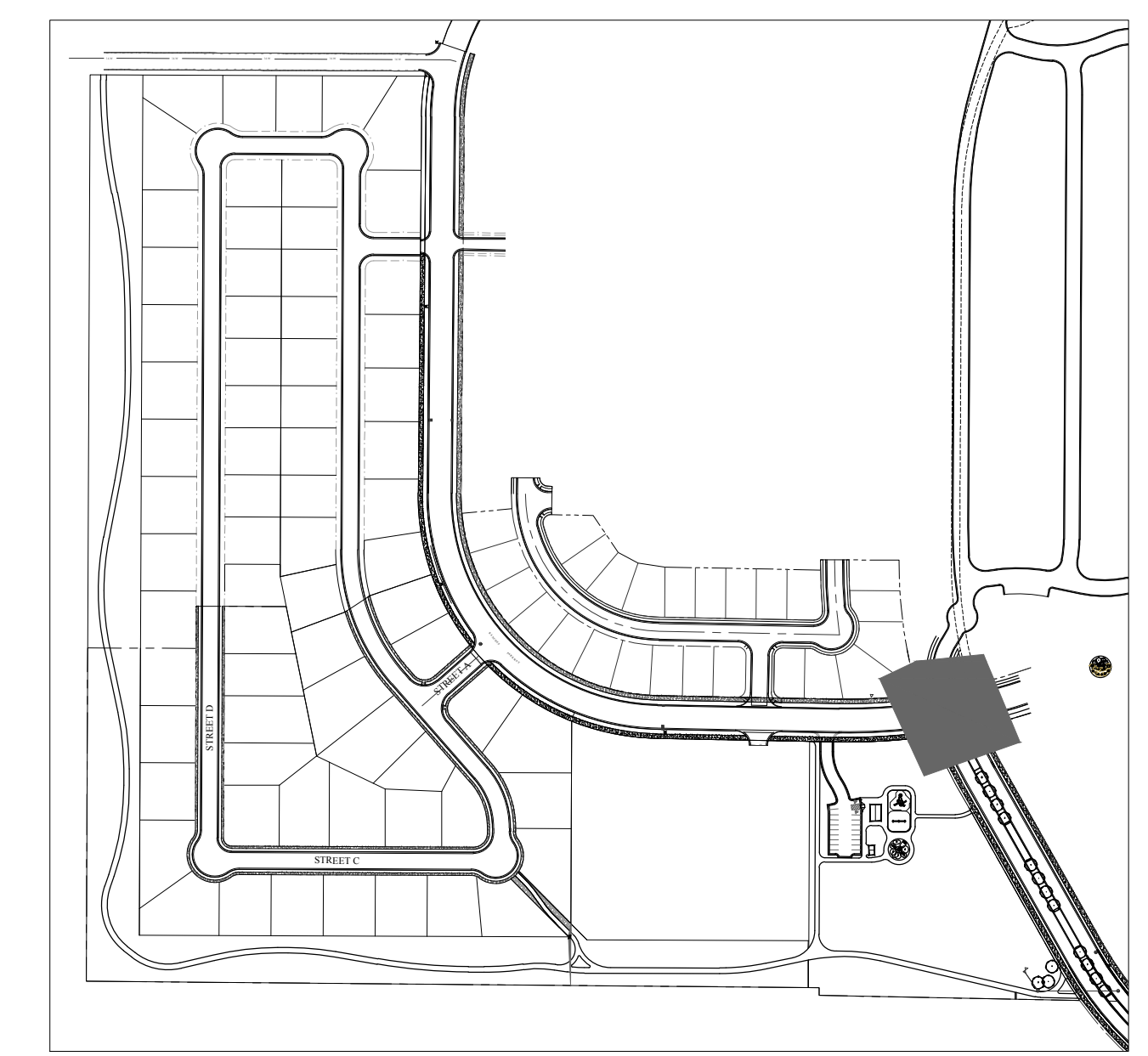
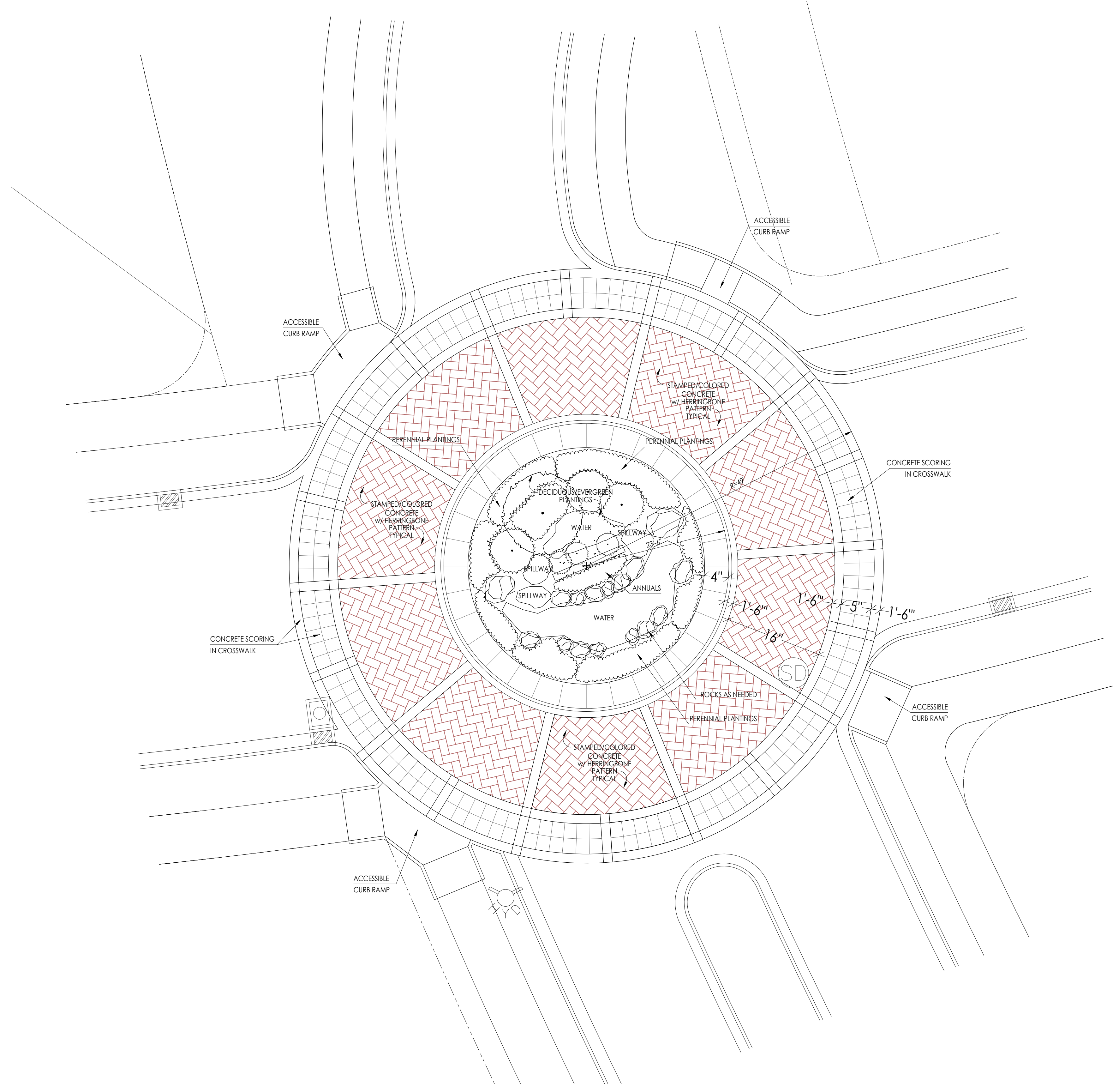

1 Roundabout Detail
L5 Not to Scale

SPRING RUN PARKS
PHASE 1
EAGLE MOUNTAIN, UTAH

PROJECT NO. 15040
DATE: November 9, 2016
REVISIONS:

SHEET TITLE:
Roundabout
Detail

SHEET NUMBER:
L5
SITE

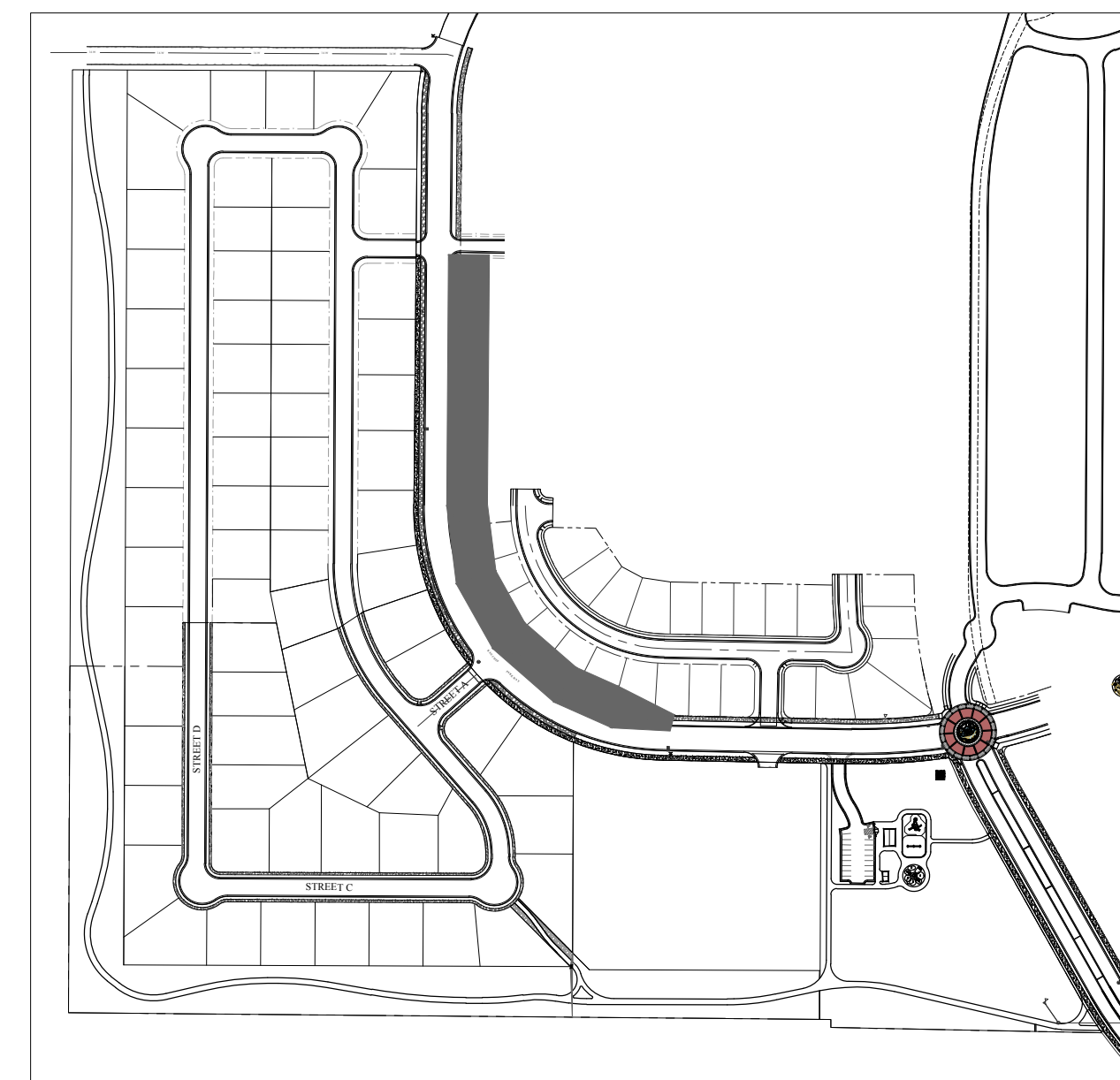
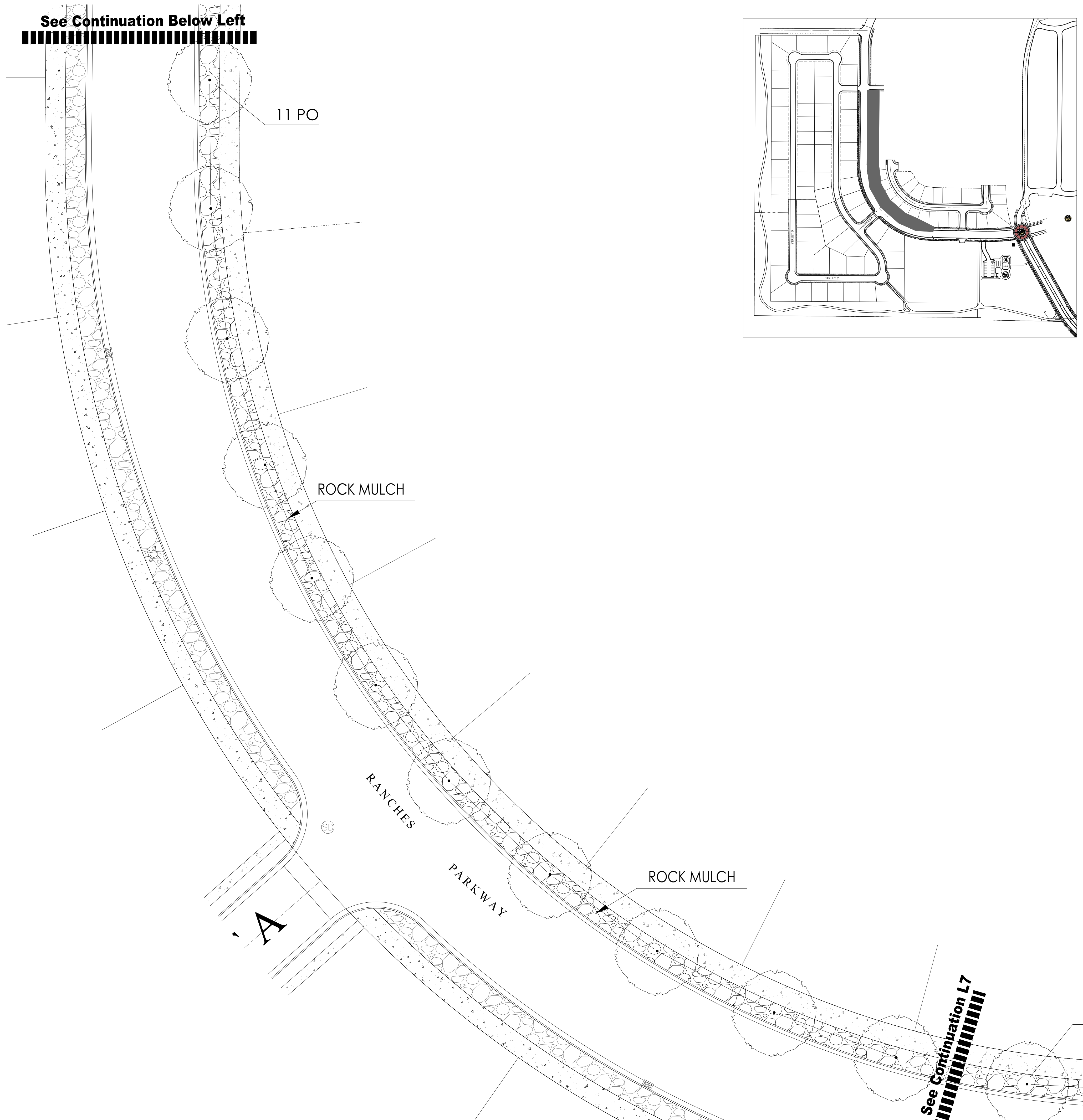
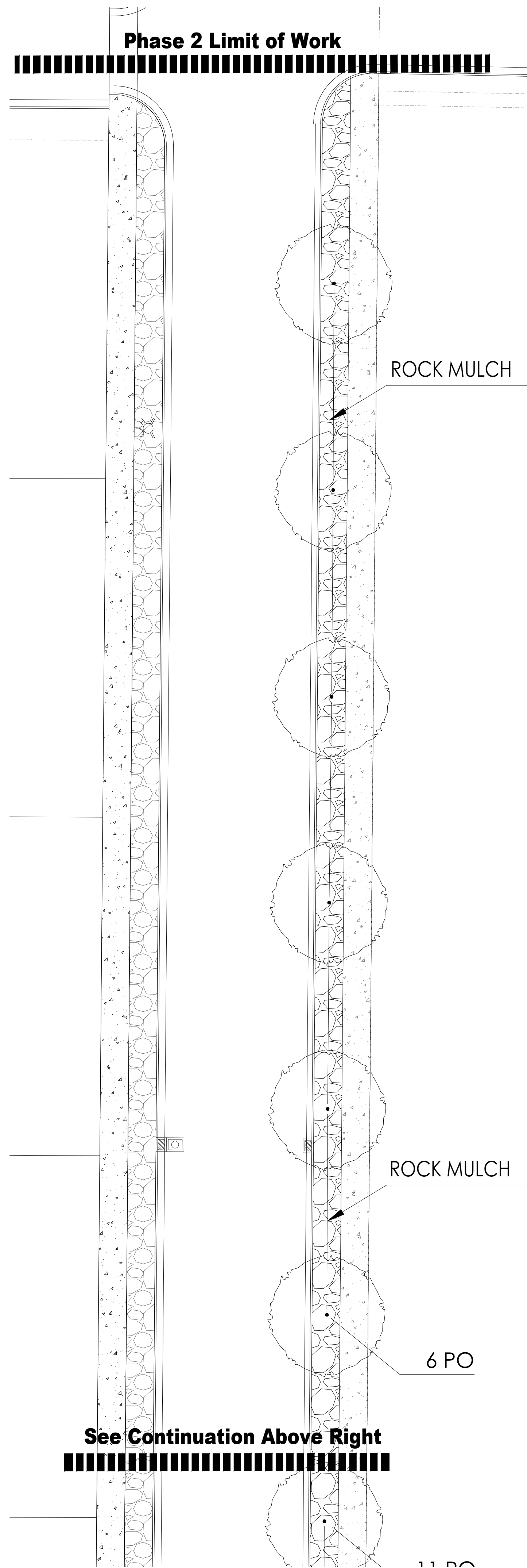

Think
Architecture

Architecture
Interior Design
Landscape Architecture
Land Planning
Construction Management

5151 South 900 East, Suite 200
Salt Lake City, UT 84117
Ph: 801.269.0055
Fax: 801.269.1425
www.thinkpk.com

The designs shown and described herein including all technical drawings, graphic representation & models thereof, are proprietary & can not be copied, duplicated, or commercially exploited in whole or in part without the sole and express written permission from ADW&A Architects, Inc.

These drawings are available for limited review and evaluation by clients, consultants, contractors, government agencies, vendors, and office personnel only in accordance with this notice.

SPRING RUN PARKS
PHASE 2
EAGLE MOUNTAIN, UTAH

PROJECT NO. 15040
DATE: November 9, 2016

REVISIONS:

SHEET TITLE:
Phase 2
Planting Plan

SHEET NUMBER:

L6

SITE

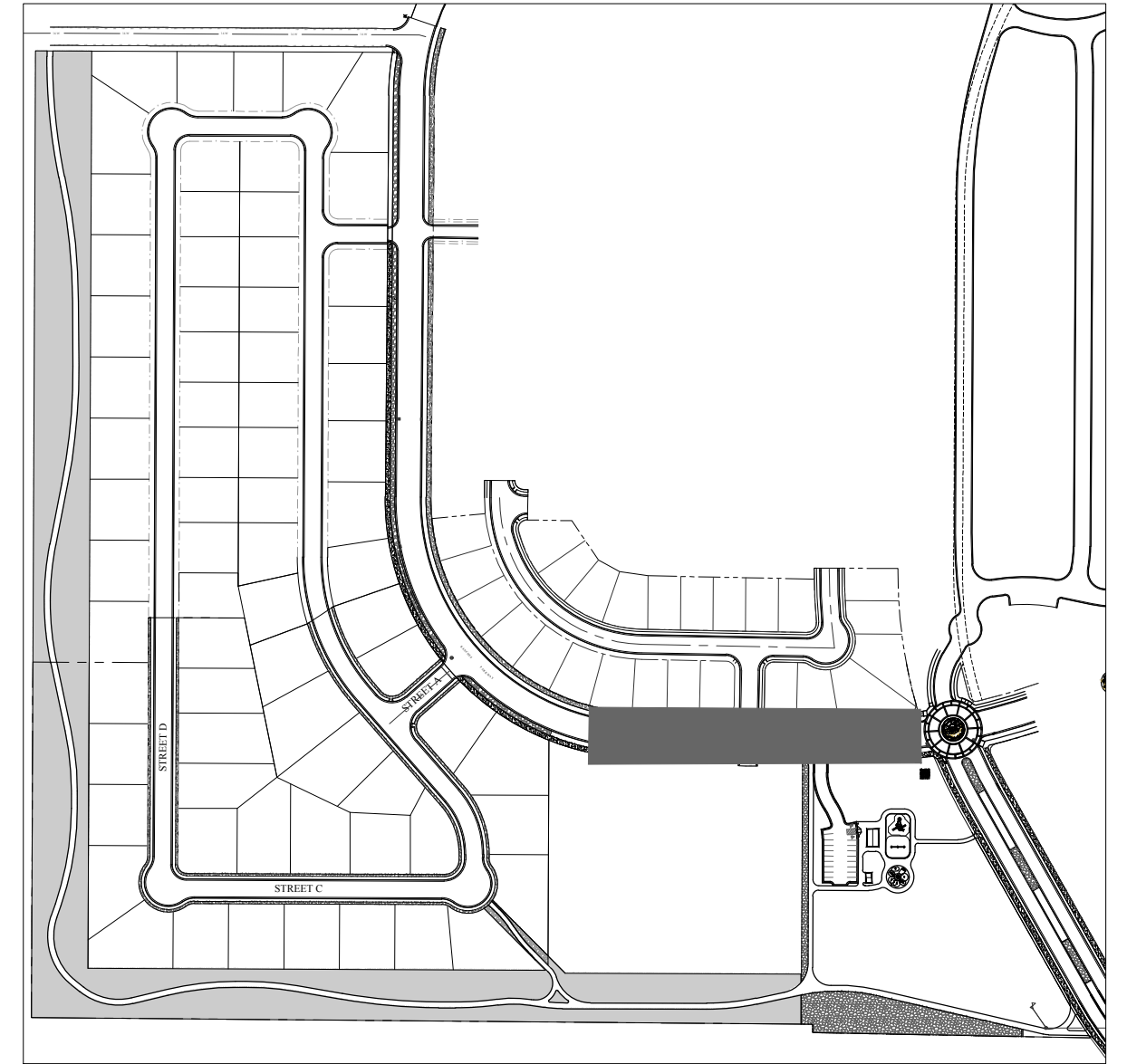
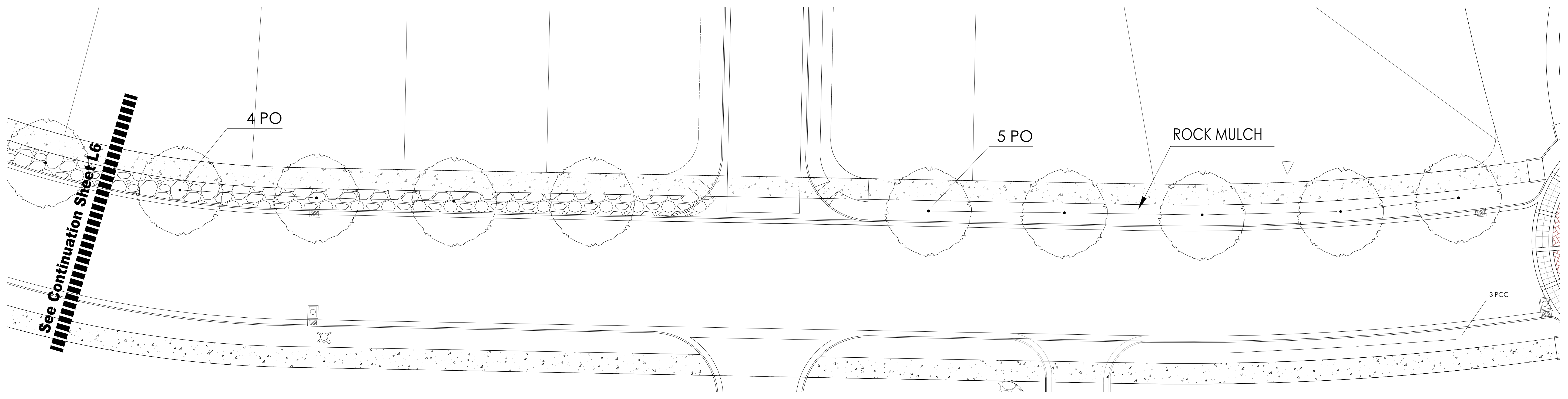

Plant List

KEY	QTY	BOTANICAL NAME	COMMON NAME	SIZE
PO	26	Platanus occidentalis	Sycamore	2" cal.

Planting Notes

- All nursery stock shall meet the horticultural standards of the American Association of Nurserymen as to grading and quality.
- All plants shall conform to the measurements specified, except that plants larger than those specified may be used if approved by the Landscape Architect.
- All plants shall be nursery grown in accordance with good horticultural practices and shall be grown under climatic conditions similar to those in the project locally for at least two years.
- Balled and burlapped plants (B&B) shall be moved with the root system as solid units; root balls shall be firmly wrapped with burlap. Container grown plants shall not be removed from container prior to the time of installation; root system shall be firmly set in container.
- Planting soil mix shall consist of seven (7) parts loam and one (1) part peat moss by volume, with a pH value of 5.0 to 6.0.
- All trees to be guyed as shown in details.
- All trees and shrubs to receive two (2) fertilizer packets as shown in details.
- Planting beds to receive 4 inch depth of bark mulch.
- All plant material shall be guaranteed for one full growing season (one year) after installation.
- Any plant material which dies, turns brown or unexpectedly defoliates prior to acceptance of work shall be promptly removed from the site and replaced with material of the same species, quality, size and meeting all planting specifications.
- Planting layout shall be approved by the Landscape Architect prior to installation.

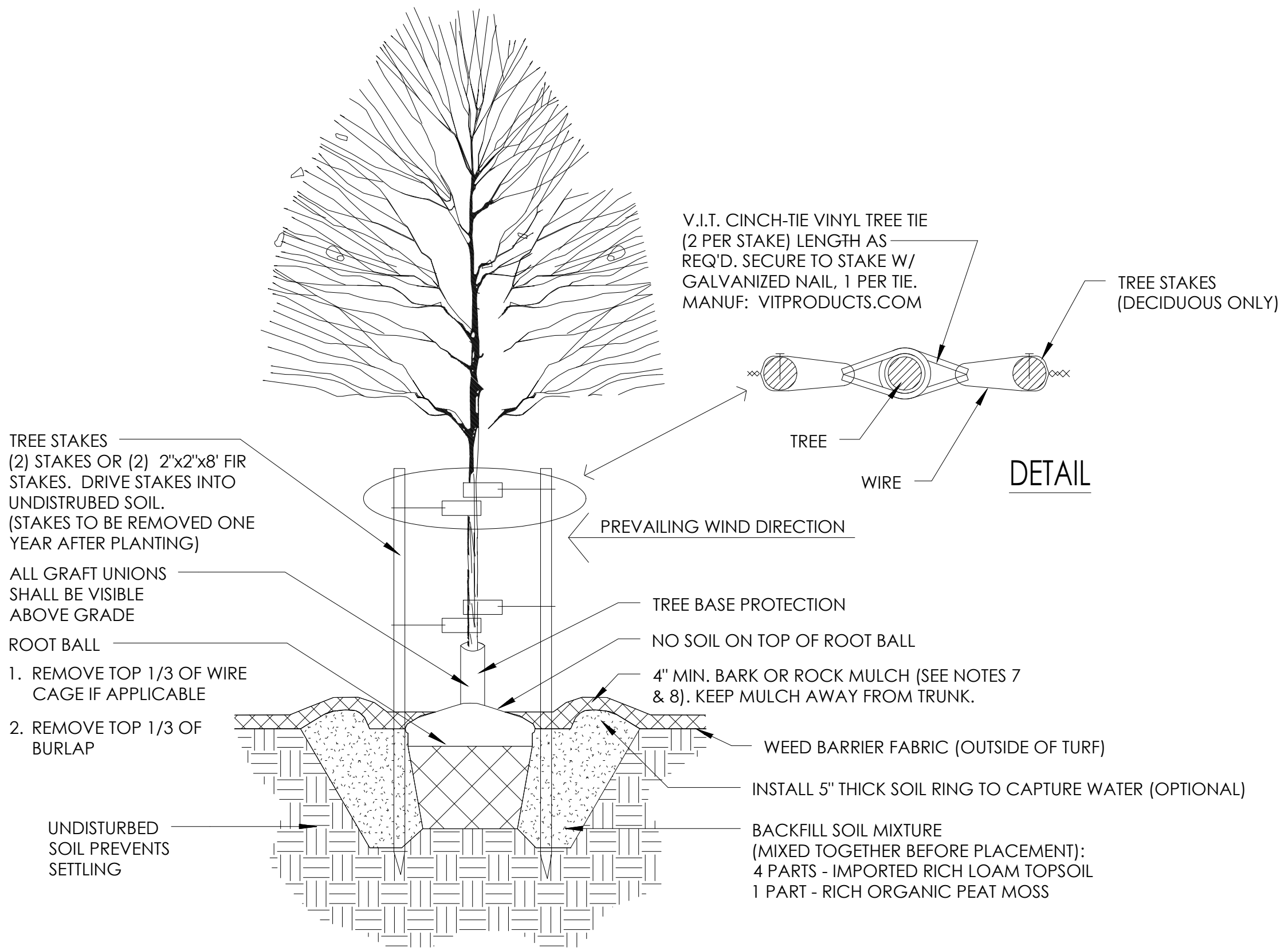

1 Deciduous Tree Planting Detail
L7 Not to Scale

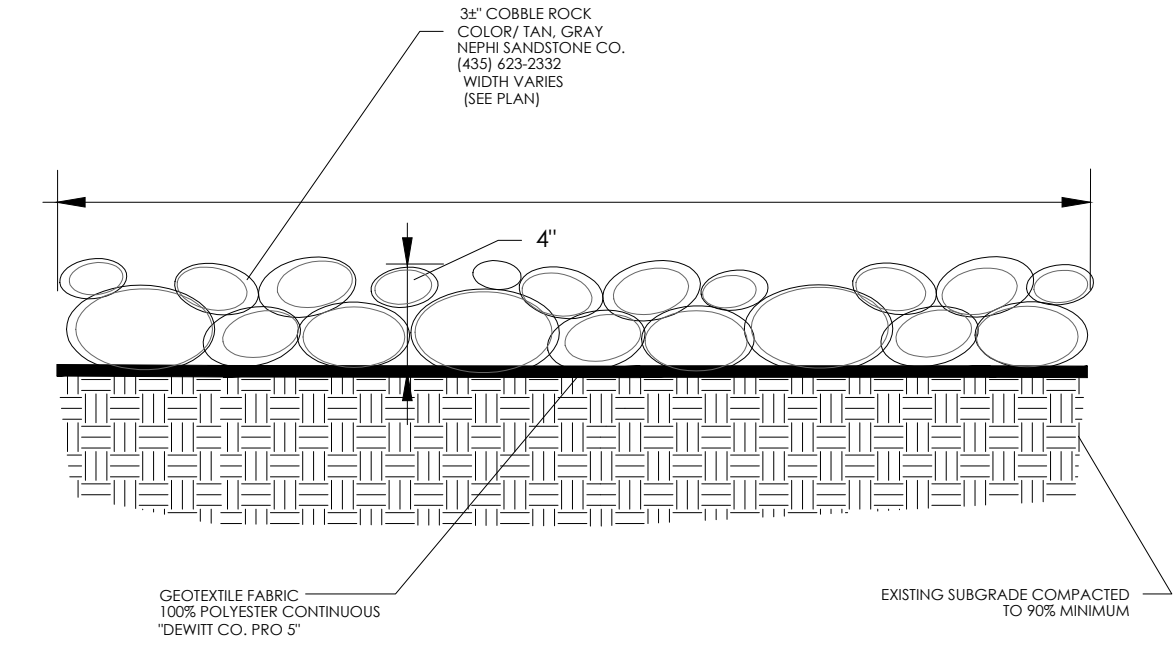

2 Rock Mulch Detail
L7 Not to Scale



Think

Architecture
Interior Design
Landscape Architecture
Land Planning
Construction Management

5151 South 900 East, Suite 200
Salt Lake City, UT 84117
Ph: 801.269.0355
Fax: 801.269.1425
www.thinkasec.com

The designs shown and described herein including all technical drawings, graphic representation & models thereof, are proprietary & can not be copied, duplicated, or commercially exploited in whole or in part without the sole and express written permission from ASWN+ISA Architects, Inc.
These drawings are available for limited review and evaluation by clients, consultants, contractors, government agencies, vendors and office personnel only in accordance with this notice.

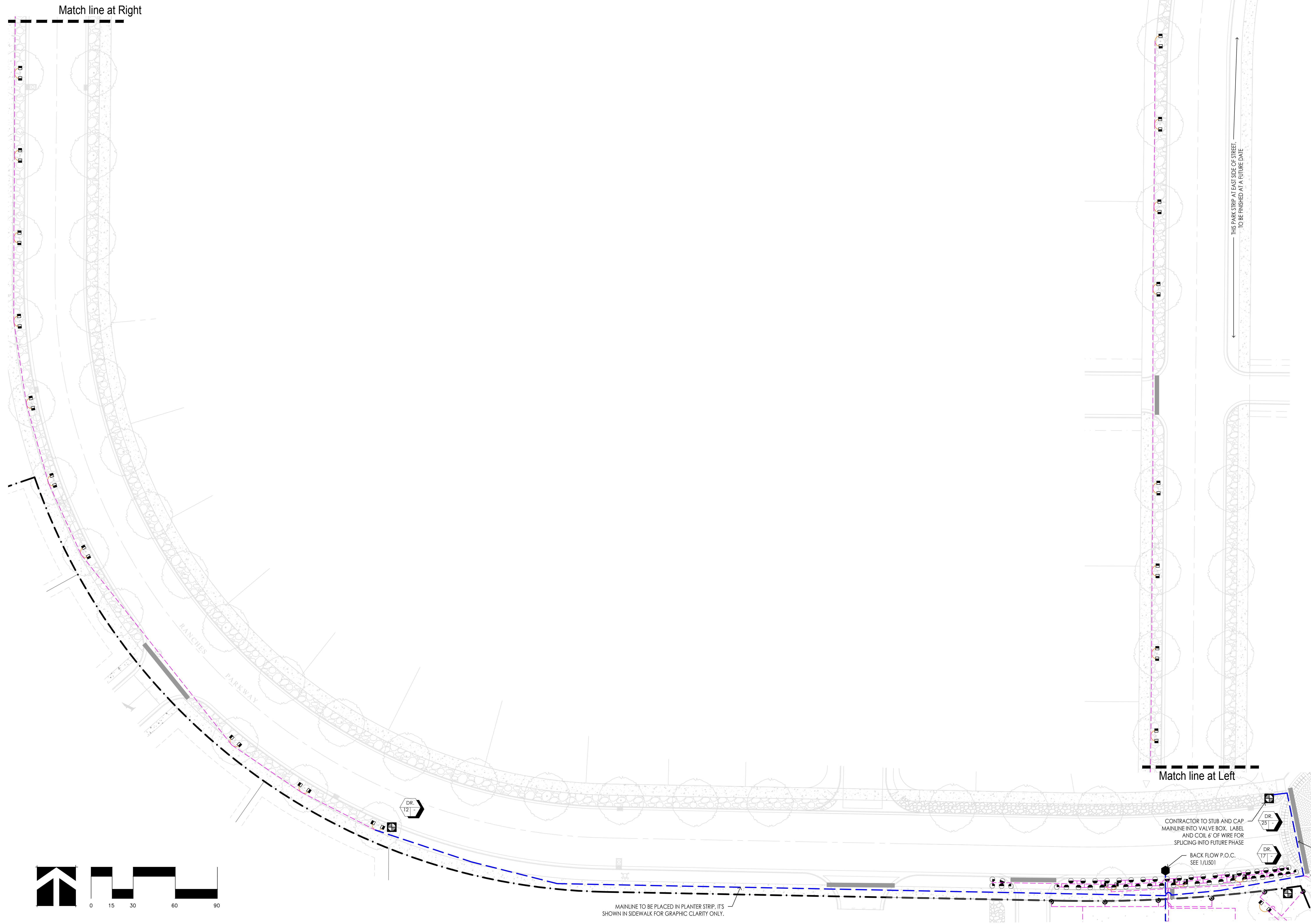

THIS PARK STRIP AT EAST SIDE OF STREET TO BE FINISHED AT A FUTURE DATE

Match line at Left

Match line at Right

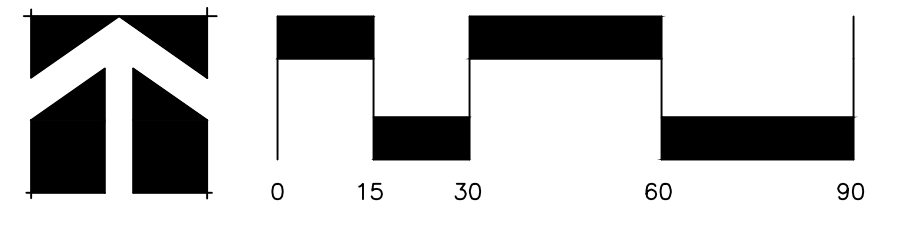

MAINLINE TO BE PLACED IN PLANTER STRIP, IT'S SHOWN IN SIDEWALK FOR GRAPHIC CLARITY ONLY.

CONTRACTOR TO STUB AND CAP MAINLINE INTO VALVE BOX. LABEL AND COIL 6' OF WIRE FOR SPlicing INTO FUTURE PHASE

BACK FLOW P.O.C. SEE 1/LI501

SPRING RUN PARK
EAGLE MOUNTAIN, UTAH

PROJECT NO. 15040
DATE: Nov. 10, 2016
REVISIONS:

SHEET TITLE:
PHASE 1
IRRIGATION PLAN
SHEET NUMBER:

LI 102
SITE



Think
Architecture

Architecture
Interior Design
Landscape Architecture
Land Planning
Construction Management

5151 South 900 East, Suite 200
Salt Lake City, UT 84117
Ph: 801.269.0355
Fax: 801.269.1425
www.thinkasec.com

The designs shown and described herein including all technical drawings, graphic representation & models thereof, are proprietary & can not be copied, duplicated, or commercially exploited in whole or in part without the sole and express written permission from ASW+JA Architects, Inc.

These drawings are available for limited review and evaluation by clients, consultants, contractors, government agencies, vendors and office personnel only in accordance with this notice.

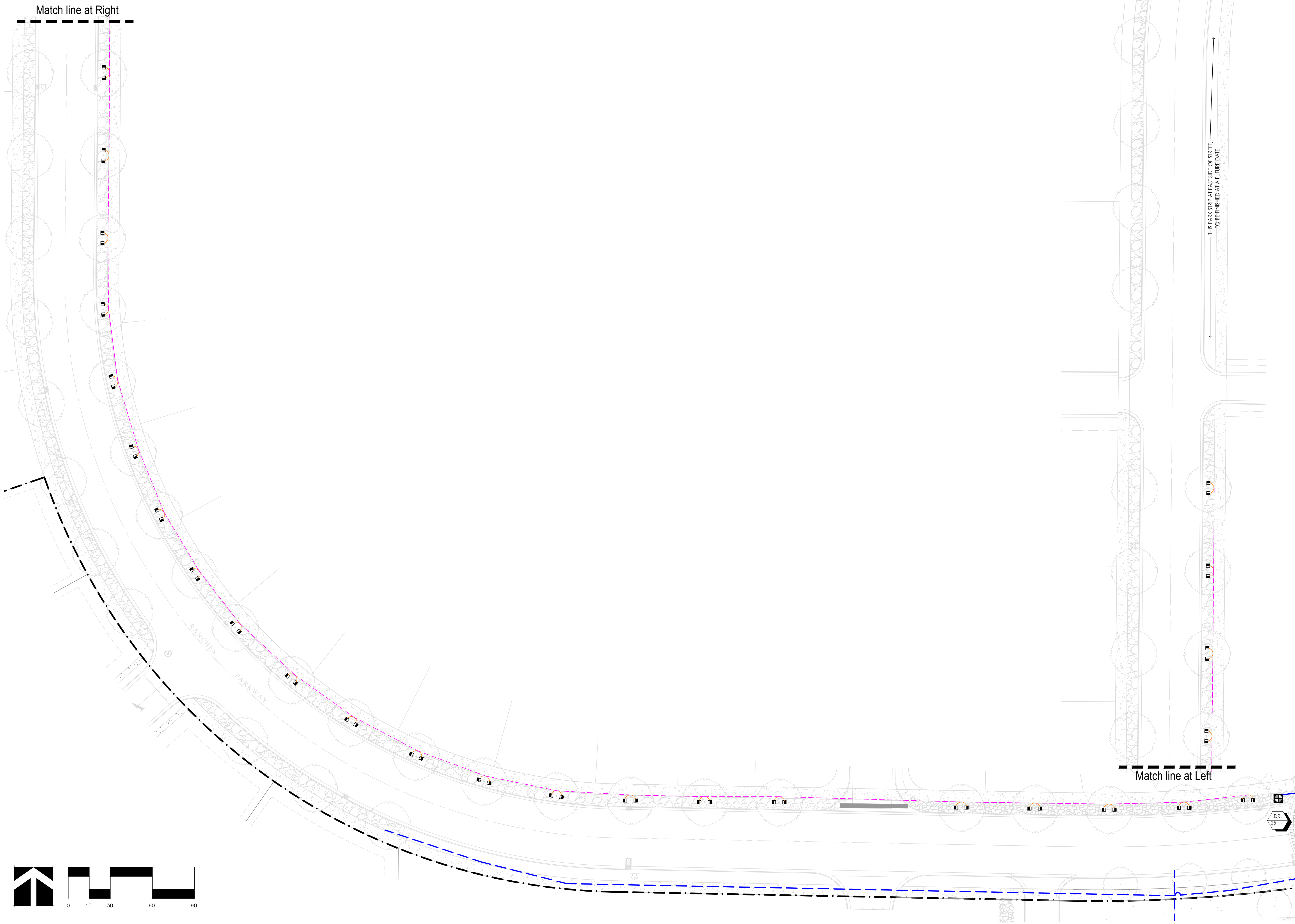

THIS PARK STRIP AT EAST SIDE OF STREET TO BE FINISHED AT A FUTURE DATE

SPRING RUN PARK
EAGLE MOUNTAIN, UTAH

PROJECT NO. 15040
DATE: Nov. 10, 2016
REVISIONS:

SHEET TITLE:
PHASE 2
IRRIGATION PLAN
SHEET NUMBER:

LI 103
SITE

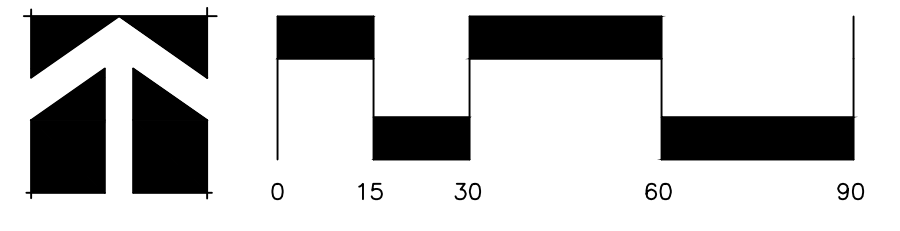

DR: [initials]

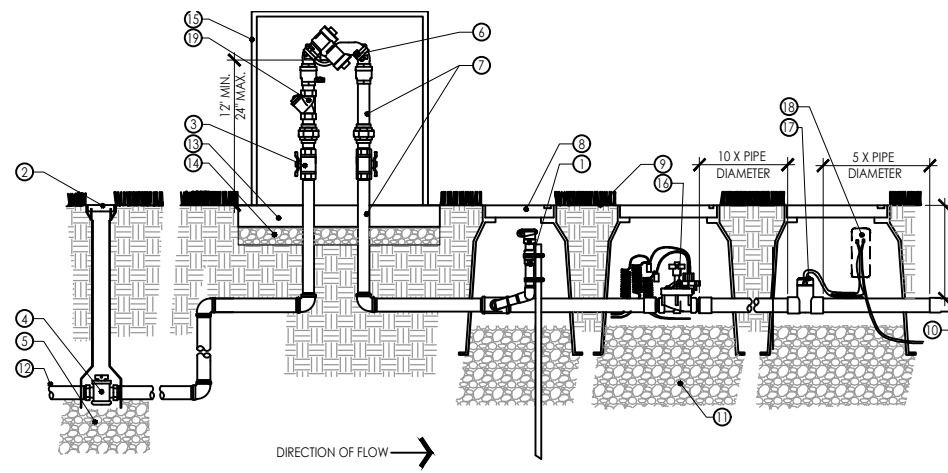

- 1 QUICK COUPLER VALVE: RAINBIRD-44-NP
- 2 CURB BOX, LENGTH AS REQUIRED
- 3 BRONZE BALL VALVE
- 4 STOP AND WASTE VALVE, SIZE TO MATCH MAIN LINE
- 5 GRAVEL DRAIN SUMP, 3/4" WASHED GRAVEL, 3 CU. FT. MINIMUM
- 6 BACKFLOW PREVENTER: WILKINS 375/375A SERIES OR ALTERNATE AS APPROVED BY CITY AND OWNER. SIZE AS REQ'D. FOR MAINLINE, PRESSURE LOSS AND FLOW REQ. INDICATED
- 7 GALVANIZED PIPE AND FITTINGS UNLESS OTHERWISE INDICATED
- 8 VALVE BOX WITH LID, TYPICAL
- 9 FINISH GRADE
- 10 SCH 40 PVC PIPE IRRIGATION MAIN LINE, SIZE PER PLAN
- 11 3/4" WASHED GRAVEL, 6" MINIMUM DEEP

NOTE:
 1. ALL VALVE BOXES TO HAVE BRICK FOUNDATIONS.
 2. LOCATION OF BACKFLOW PREVENTER TO BE APPROVED BY LANDSCAPE ARCHITECT.
 3. BACKFLOW PREVENTER TO BE INSTALLED IN ACCORDANCE WITH LOCAL CODE.
 4. PROVIDE 12" MINIMUM CLEARANCE ON ALL SIDES OF BACKFLOW PREVENTER.

BACKFLOW PREVENTER ASSEMBLY 1

- 12 MAIN LINE FROM WATER METER
- 13 4" CONCRETE PAD
- 14 6" GRAVEL OVER COMPACTED SUB-BASE
- 15 V.I.T PRODUCTS / STRONG BOX, STAINLESS STEEL VANDAL RESISTANT ENCLOSURE, SIZED TO ACCOMMODATE EQUIPMENT
- 16 MASTER VALVE:
 MAINLINE 3/4"-2.5" - RAINBIRD PESB SERIES
 MAINLINE 3"-4" - RAINBIRD 300-BPE BRASS VALVE
 LEAVE 36" LENGTH OF COILED WIRE TO CONTROLLER, SEE IRRIGATION LEGEND
- 17 FLOW SENSOR: RAINBIRD FS-XXX-P
 LEAVE 36" LENGTH OF COILED PE-CABLE TO FLOW SENSING EQUIPMENT AT CONTROLLER, SEE IRRIGATION LEGEND
- 18 WIRE SPLICE, SEE MANUFACTURER'S RECOMMENDATIONS
- 19 "Y" TYPE STRAINER

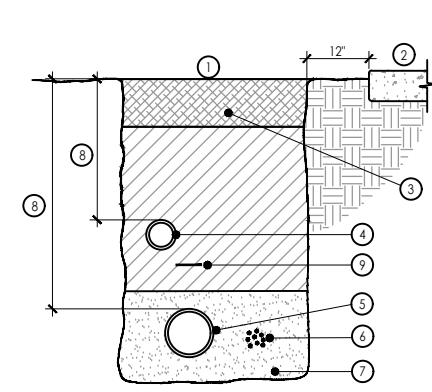

- 1 IF LAWN IS EXISTING, REPLACE SOD AS PER OWNER'S SPECIFICATIONS
- 2 ADJACENT HARD SURFACE
- 3 TOPSOIL FREE FROM ROCKS GREATER THAN 1" DIAMETER. LAYER THICKNESS AS INDICATED IN PLANTING NOTES
- 4 NON-PRESSURE LATERAL LINE
- 5 PRESSURE MAIN LINE
- 6 DIRECT BURIAL, LOW VOLTAGE CONTROL WIRES; TAPE AND BUNDLE AT 10" O.C. PLACE 6" EITHER SIDE, OR 6" BELOW MAIN LINE PIPE.
- 7 MORTAR SAND BEDDING 2" BELOW AND ABOVE PIPE
- 8 PIPE DEPTHS:
 MAIN LINE: 24 - 30" COVER
 LATERAL LINE: 8 - 16" COVER
 BACKFILL SOIL FREE FROM ROCKS GREATER THAN 1" DIAMETER.
- 9 DETECTABLE WARNING TAPE AT MAIN LINE

TRENCH DETAIL 3

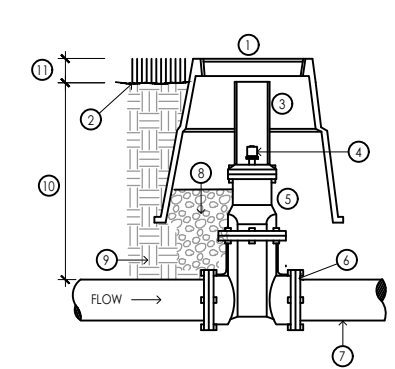

- 1 10" ROUND GREEN PLASTIC VALVE BOX, W/ BOLT LOCK, CARSON-BROOKS 910
- 2 FINISH GRADE
- 3 6" PVC SCH. 40 PIPE SLEEVE, 4" - 6" BELOW GRADE
- 4 OPERATING NUT AS DETERMINED BY OWNER (SQUARE NUT / T-HEAD / HANDWHEEL)
- 5 FLANGE x FLANGE GATE VALVE SEE IRRIGATION LEGEND
- 6 SCH. 80 FLANGE ADAPTER
- 7 MAIN WATER SUPPLY LINE
- 8 6" MIN. LAYER OF 3/4" GRAVEL
- 9 SUBGRADE COMPACTED TO 90%
- 10 DEPTH: 18" - 30"
- 11 SHRUBS-2"; SOD-1 1/2"; SEED-1"

NOTE:
 1. CONTRACTOR TO PROVIDED (2) VALVE OPERATING KEYS TO OWNER.

MANUAL GATE VALVE 3

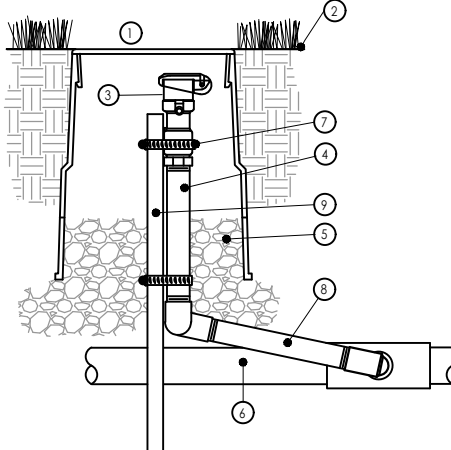

- 1 10" ROUND GREEN PLASTIC VALVE BOX, FINISH GRADE
- 2 QUICK COUPLER - SEE EQUIPMENT SCHEDULE (MOUNT 4 - 6" BELOW GRADE)
- 3 1" GALVANIZED RISER, LENGTH AS REQUIRED
- 4 6" MIN. DEPTH 3/4" WASHED GRAVEL
- 5 MAIN SUPPLY LINE
- 6 SECURE VALVE TO REBAR WITH (2) MIN. STAINLESS STEEL SCREW CLAMPS
- 7 1" DOUBLE ELBOW SWING JOINT ASSEMBLY
- 8 #4 REBAR, DRIVEN INTO SOIL 18" MIN.

NOTE:
 1. INSTALL (1) QUICK COUPLING VALVE IN LOCATIONS INDICATED ON PLAN
 2. INSTALL VALVE BOX SO TOP OF BOX IS AT FINISH GRADE IN TURF AND 2" ABOVE FINISH GRADE IN PLANTING AREAS.
 3. TOP OF QUICK COUPLER VALVE TO HAVE 3" MIN. CLEARANCE FROM VALVE BOX LID

QUICK COUPLING VALVE ASSEMBLY 4

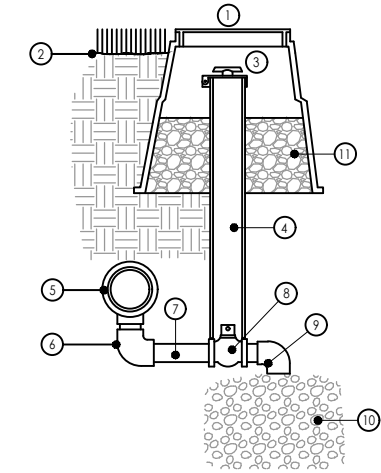

- 1 10" ROUND VALVE BOX W/ LOCK BOLT, CARSON-BROOKS 910
- 2 FINISH GRADE
- 3 LOCKING CAP PERMANENTLY ATTACHED TO SLEEVE, 4" CLEAR
- 4 2" PVC SCH. 40 SLEEVE NOTCHED OVER VALVE
- 5 PVC SCH. 80 TEE & MAIN LINE
- 6 3/4" PVC SCH. 80 ELBOW
- 7 3/4" PVC SCH. 80 NIPPLE (LENGTH AS REQUIRED)
- 8 3/4" BALL VALVE
- 9 3/4" MARLEX STREET ELBOW
- 10 GRAVEL SUMP - 18" x 18" x 12" MIN. SIZE
- 11 3/4" GRAVEL FILL TO 3" BELOW TOP OF SLEEVE

NOTE:
 1. ALL PVC NIPPLES TO BE SCH. 80
 2. PROVIDE VALVE KEY TO OWNER
 3. INSTALL AT ALL LOW POINTS OF MAIN LINE FOR ADEQUATE DRAINAGE

MANUAL DRAIN VALVE ASSEMBLY 5

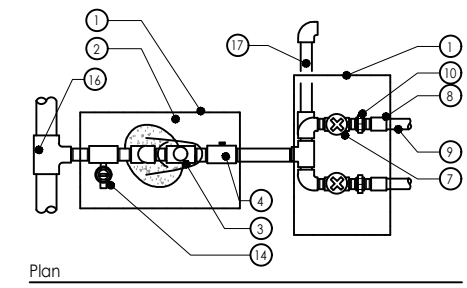
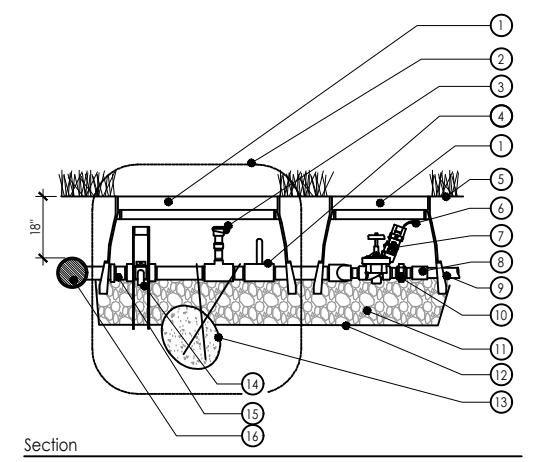

- 1 PLASTIC VALVE BOX (WITH EXTENSION AS NEEDED) AND LOCK DOWN LID
- 2 PRE-VALVE MANIFOLD ASSEMBLY
- 3 QUICK COUPLER VALVE WITH SCH. 80 NIPPLE INTO SCH.80 TEE (TOP OF VALVE TO BE 3" MAX. BELOW BOTTOM OF LID WITH PROPER CLEARANCE FOR KEY)
- 4 BRASS BALL VALVE WITH HANDLE TURNED UPWARDS FOR 'OFF' POSITION
- 5 FINISH GRADE
- 6 CONTROL WIRE CONNECTION WITH 18 - 24" WIRE COILED FOR SERVICE
- 7 ELECTRIC CONTROL VALVE
- 8 SCH. 80 PVC COUPLING
- 9 PVC LINE TO SPRINKLERS
- 10 SCH. 80 PVC THREADED UNION WITH SCH. 80 PVC NIPPLE ON OUTLET SIDE
- 11 6" MIN. LAYER OF 3/4" MINUS GRAVEL
- 12 FABRIC LINER
- 13 CONCRETE THRUST BLOCK WITH 2" #3 BARS WRAPPED AROUND FITTING AS SHOWN
- 14 MANUAL DRAIN VALVE
- 15 SCH. 80 FITTINGS THROUGHOUT MANIFOLD
- 16 MAIN LINE FITTING
- 17 4" SCH. 80 PVC PIPE (LENGTH AS REQ'D)

NOTES:
 1. LANDSCAPE CONTRACTOR SHALL BE RESPONSIBLE FOR COMPLETE DRAINAGE OF THE CONTROL VALVE MANIFOLD.
 2. INSTALL SCH. 80 PVC FITTING THROUGHOUT MANIFOLD.
 3. ALL VALVE BOXES SHALL SIT ON 8" MIN. GRAVEL LAYER WITH FABRIC LINER.
 4. OPENING IN VALVE BOX FOR PIPING TO BE LARGE ENOUGH FOR BOX TO NOT REST ON PIPING.
 5. VALVE BOX SIZE TO BE SUFFICIENT TO REMOVE VALVE WITH BOX IN PLACE.

ELECTRIC REMOTE CONTROL VALVE MANIFOLD 6

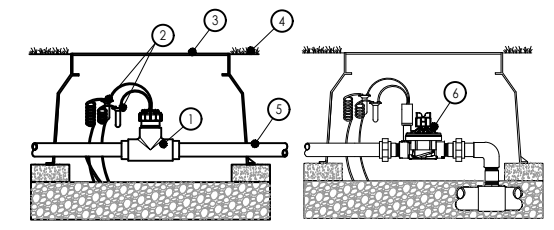

- 1 MODEL FS-XXX-P
- 2 MIN. 18/2 WIRE TO ACC POWER MODULE. MAXIMUM WIRE DISTANCE RUN OF 2,000'
- 3 STANDARD VALVE BOX
- 4 FINISH GRADE
- 5 MAIN LINE PIPE
- 6 MASTER VALVE

NOTE:
 1. INLET PIPE LENGTH OF SENSOR MUST BE MIN. 10X PIPE DIA. STRAIGHT, CLEAN RUN OF PIPE. NO FITTINGS OR TURNS. OUTLET PIPE LENGTH OF SENSOR MUST BE MIN. 5X PIPE DIA. OF STRAIGHT CLEAN RUN OF PIPE. NO FITTINGS OR TURNS.

FLOW SENSOR 7

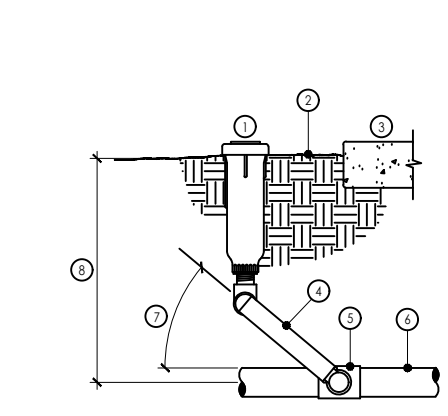

- 1 POP-UP ROTOR SPRINKLER - SEE LEGEND TOP OF ROTOR POP-UP SPRINKLER FLUSH WITH SIDEWALK
- 2 FINISH GRADE
- 3 NOTE: ALL SPRAY HEADS TO BE PLACED 1/2" - 1" CLEAR OF ALL HARDSCAPE SURFACES
- 4 SCH. 80 THREADED NIPPLE W/ MARLEX STREET ELBOWS
- 5 PVC SCH. 40 SxSxT TEE (OR ELL)
- 6 PVC LATERAL LINE, SIZE AS NOTED ON PLAN
- 7 SWING JOINT ARM INSTALLED AT ANGLE BETWEEN 30 AND 45 DRG. OF LATERAL PIPE. USE MALE THREAD MODEL
- 8 DEPTH - SEE NOTES & TRENCH DETAIL

ROTOR POP-UP SPRINKLER 8

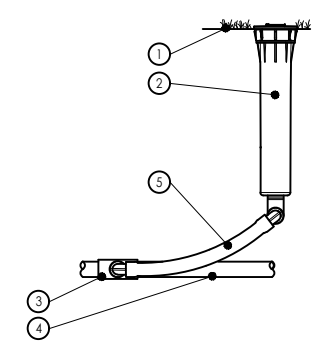

- 1 FINISH GRADE
- 2 MODEL: 1804 BODY, SEE SCHEDULE FOR NOZZLE
- 3 LATERAL TEE OR ELL
- 4 LATERAL PIPE
- 5 SWING JOINT: RAINBIRD SP-100 TUBING, SBE-050 ELBOWS (2)

ROTARY NOZZLE ON POP-UP 9

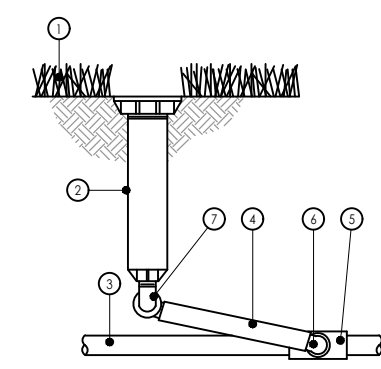

- 1 FINISH GRADE/TOP OF MULCH
- 2 POP-UP SPRAY SPRINKLER: SEE LEGEND
- 3 PVC LATERAL PIPE
- 4 SWING ASSEMBLY: 6504 TSJ-100-PRS w/ 70 P.S.I. P.R. 5004 TSJ-075-PRS w/ 45 P.S.I. P.R.
- 5 PVC SCH 40 SxSxT TEE OR ELL
- 6 1/2" BARB 90d
- 7 1/2" MARLEX 90d ELL

POP-UP SPRINKLER (LAWN AREA) 10

5151 South 900 East, Suite 200
 Salt Lake City, UT 84117
 PH: 801.269.0055
 FAX: 801.269.1425
 www.thinkaec.com

The designs shown and described herein including all technical drawings, graphic representation & models thereof, are proprietary & can not be copied, duplicated, or commercially exploited in whole or in part without the sole and express written permission from ASW+JA Architects, Inc.
 These drawings are available for limited review and evaluation by clients, consultants, contractors, government agencies, vendors, and office personnel only in accordance with this notice.

PROJECT NO. 15040
 DATE: Nov. 10, 2016
 REVISIONS:

SHEET TITLE:
 IRRIGATION DETAILS
 SHEET NUMBER:

LI501
 SITE